

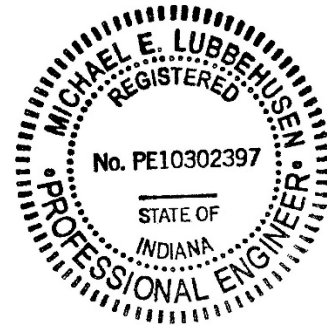

**Primary Engineering, Inc.**  
2828 Lake Ave.  
Fort Wayne, Indiana 46805  
260-424-0444 ph  
www.primary-eng.com



Addendum: 2

Date: **12/12/2024**

Project: **2025 FWCS Electrical PPI**

Comm #: **24664**

The following items shall be incorporated into the specifications and drawings and are considered to be integral to the bid documents for the project. Acknowledgement of receipt of this addendum is required on the bid form.

**Item #1: Drawing Sheet NS-E201, Media Center Lighting Demolition and New Plans**

- A. Additional power and data to be removed from casework. Refer to supplemental drawing NS-E201 for more information.
- B. Changes to floor box quantity and locations. Refer to supplemental drawing NS-E201 for more information.
- C. Changes to note referring to projector installation. Refer to supplemental drawing NS-E201 for more information.
- D. Added 2'x2' floor access with door in Office D237. Refer to supplemental drawing NS-E201 for more information.

**Item #2: Drawing Sheet E401, Electrical Details**

- A. Changes to projector detail. Refer to supplemental drawing E401 for more information.

**Item #3: Drawing Sheet E501, Electrical Schedules**

- A. Changes to floor box schedule. Refer to supplemental drawing E501 for more information.

All concepts, ideas, plans, and details as shown on this document are the sole property of Primary Engineering, Inc. and shall not be used for any other purpose without their express written consent. The project owner shall be permitted to retain copies for information and reference purposes.  
 2024 © Primary Engineering, Inc.

ADDENDUM #2 12-12-2024



**FORT WAYNE COMMUNITY SCHOOLS**  
**2025 Physical Plant Improvements**  
 Electrical PPI Projects  
 Fort Wayne, Indiana

CERTIFICATION:  
  
*Michael E. J. Labbe*

DATE: 11-25-2024  
 COMM: 24664  
 FILE: 664-7-NS-E201

SCHOOL: North Side High School  
 475 East State Blvd.  
 Fort Wayne Indiana 46805

TITLE:  
**MEDIA CENTER LIGHTING DEMOLITION AND NEW PLANS**

SHEET:  
**NS-E201**

E.C. SHALL VERIFY ALL EXISTING CIRCUITS IN PANELS WHERE CHANGES ARE MADE. PROVIDE NEW, TYPED, UPDATED DIRECTORY.

E.C. SHALL REPLACE CEILING TILES AS REQUIRED. COORDINATE EXACT CEILING TYPE WITH FWCS.

COORDINATE ALL WORK WITH OTHER TRADES ONSITE.

- DEMOLITION PLAN NOTES**
1. DISCONNECT AND REMOVE LIGHT FIXTURE. EXISTING CIRCUIT TO REMAIN FOR NEW FIXTURE. REMOVE WIRING BACK TO SOURCE IN LOCATIONS WHERE NO NEW FIXTURE WILL BE INSTALLED. EXISTING LIGHTING FED OUT OF PANEL 2HD1. EXISTING MIDDLE CEILING HEIGHT IS 12' 0" A.F.F.
  2. DISCONNECT AND REMOVE EXIT SIGN. PREPARE FOR INSTALLATION OF NEW FIXTURE.
  3. DISCONNECT AND REMOVE EMERGENCY LIGHT FIXTURE. REMOVE WIRING BACK TO SOURCE.
  4. REMOVE LIGHTING CONTROL SWITCH(ES), SENSOR(S), AND ASSOCIATED CONDUCTORS BACK TO SOURCE. PREPARE FOR INSTALLATION OF NEW CONTROL SWITCH. PROVIDE BLANK STAINLESS STEEL COVER PLATE AS REQUIRED ON ANY ABANDONED JUNCTION BOXES.
  5. DISCONNECT AND REMOVE WALL MOUNTED FIXTURE, JUNCTION BOX, AND ASSOCIATED WIRING BACK TO SOURCE. PATCH AND PAINT BY OTHERS.
  6. DISCONNECT AND REMOVE POWER BACK TO FLOOR AND REMOVE DATA BACK TO EXISTING FROM CASEWORK TO BE REMOVED. EXISTING POWER TO REMAIN FOR NEW FLOOR BOXES. CASEWORK TO BE REMOVED BY OTHERS.

- PLAN NOTES**
1. PROVIDE AND INSTALL NEW FIXTURE. CONNECT TO EXISTING CIRCUIT PREVIOUSLY SERVING THIS AREA. EXTEND CIRCUIT AS REQUIRED. PROVIDE AND INSTALL DIMMING CABLE FOR NEW FIXTURES. PROVIDE EMERGENCY CIRCUIT TO FIXTURES WITH GTD.
  2. PROVIDE AND INSTALL NEW EXIT SIGN. CONNECT TO SAME CIRCUIT SERVING EMERGENCY FIXTURES IN THIS SPACE AHEAD OF ANY SWITCHES, SENSORS, OR RELAYS.
  3. PROVIDE AND INSTALL NEW 20A DECORA 0-10V DIMMER SWITCH FOR NEW LIGHTING IN EXISTING DEVICE BOX. CONNECT TO EXISTING CIRCUIT(S) PREVIOUSLY SERVING LIGHTING IN THIS AREA. EXTEND EXISTING BRANCH CIRCUIT, AS REQUIRED, TO CONNECT TO NEW LIGHTING CONTROL DEVICE.
  4. CONNECT LIGHTING AND OCCUPANCY (POWER PACK) TO EXISTING LIGHTING CIRCUIT(S) PREVIOUSLY SERVING THIS AREA.
  5. PROVIDE AND INSTALL NEW PROJECTOR PLATE AND MOUNTING ASSEMBLY WITH TWO (2) HDMI INPUTS AND TWO (2) DUPLEX POWER RECEPTACLES WITH USB CHARGERS. PROJECTOR TO BE SUPPLIED BY FWCS TECHNOLOGY DEPARTMENT. COORDINATE EXACT LOCATION OF PLATE RELATIVE TO PROJECTION SCREEN WITH PROJECTOR SPECIFICATIONS. AUDIO / SPEAKERS TO BE PROVIDED AND INSTALLED BY FWCS TECHNOLOGY DEPARTMENT. PROVIDE AND INSTALL NEW 20A/1P BREAKER IN EXISTING PANEL 2LD-16.
  6. PROVIDE AND INSTALL MOTORIZED DI-LITE PROJECTOR SCREEN WITH MOTORIZED DOOR. RECESSED IN CEILING. CUT AND PATCH. SCREEN TO BE 126.25" TOTAL LENGTH WITH 130" DIAGONAL. VIEWING 89X110". 2" STANDARD BLACK DISC WITH MATTE WHITE FINISH. PROVIDE AND INSTALL REMOTE, KEY-OPERATED, 3 POSITION CONTROL SWITCH. SWITCH TO ACCEPT BEST STANDARD 7-PIN INTERCHANGEABLE CORE. CORE TO BE PROVIDED BY FWCS. COORDINATE LOCATIONS PRIOR TO INSTALLATION.
  7. PROVIDE AND INSTALL NEW FLOOR BOX. CUT AND PATCH FLOOR AS REQUIRED. CONNECT TO EXISTING POWER PREVIOUSLY REMOVED FROM DEMOED CASEWORK. COORDINATE LOCATION WITH OWNER PRIOR TO ROUGH-IN. EXTEND CIRCUITS AS REQUIRED.
  8. PROVIDE AND INSTALL 2 X 2' FLOOR ACCESS WITH DOOR IN OFFICE FLOOR. COORDINATE EXACT LOCATION PRIOR TO INSTALLATION. FLOOR ACCESS DOOR NEEDS TO BE ABLE TO HANDLE A MINIMUM OF 40 LBS.

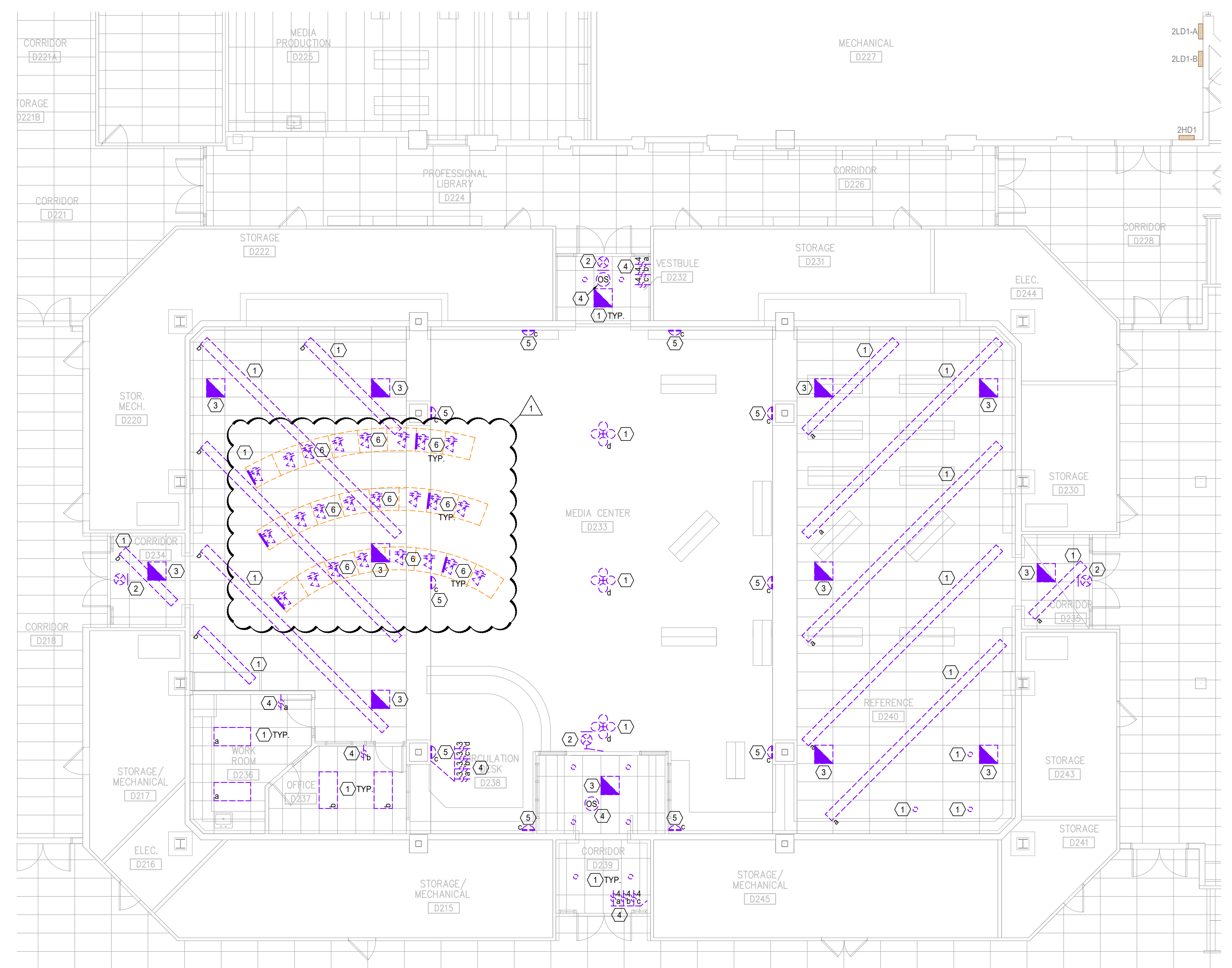

**MEDIA CENTER LIGHTING DEMOLITION PLAN**  
 SCALE: 1/8" = 1'-0"

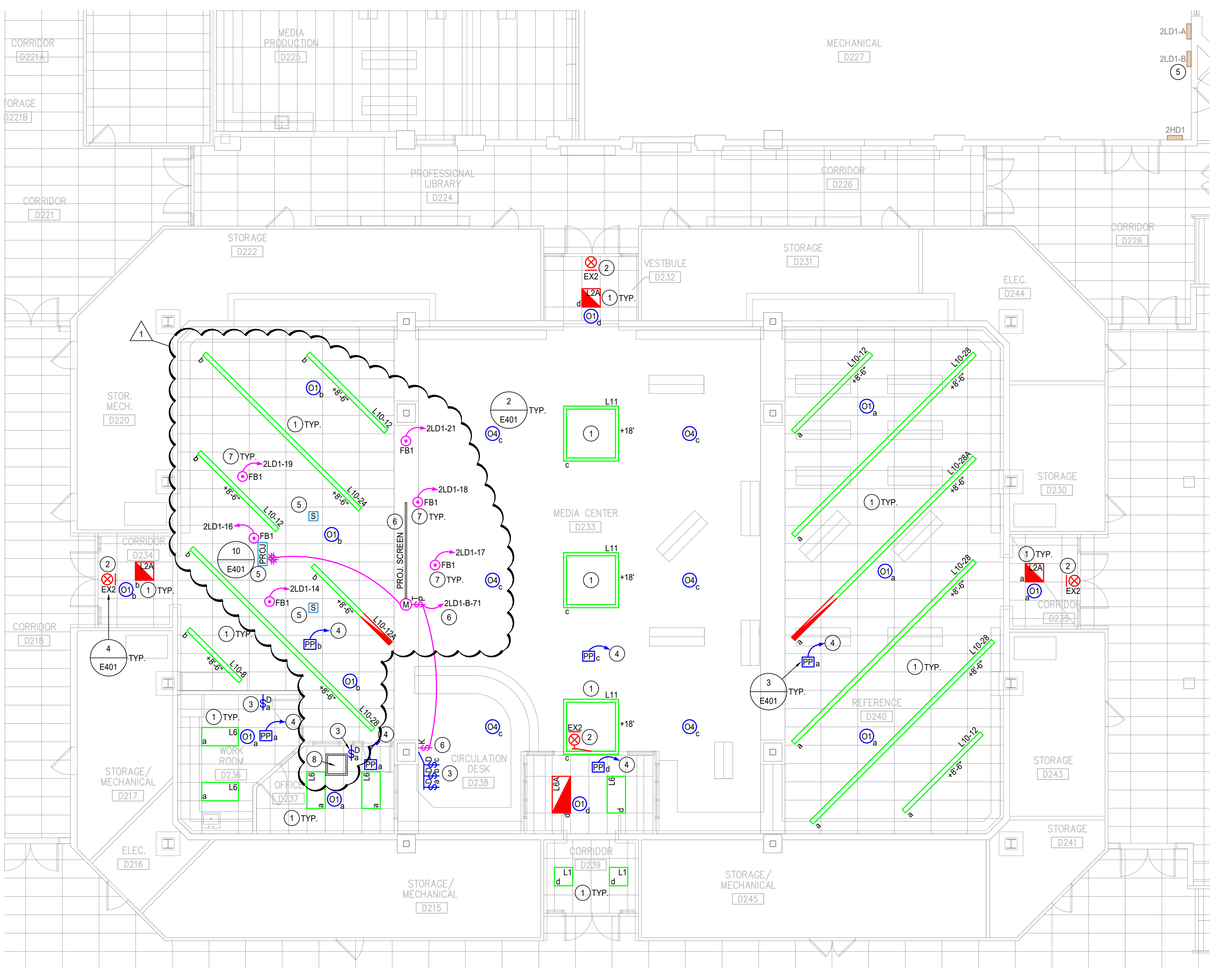

**MEDIA CENTER LIGHTING PLAN**  
 SCALE: 1/8" = 1'-0"

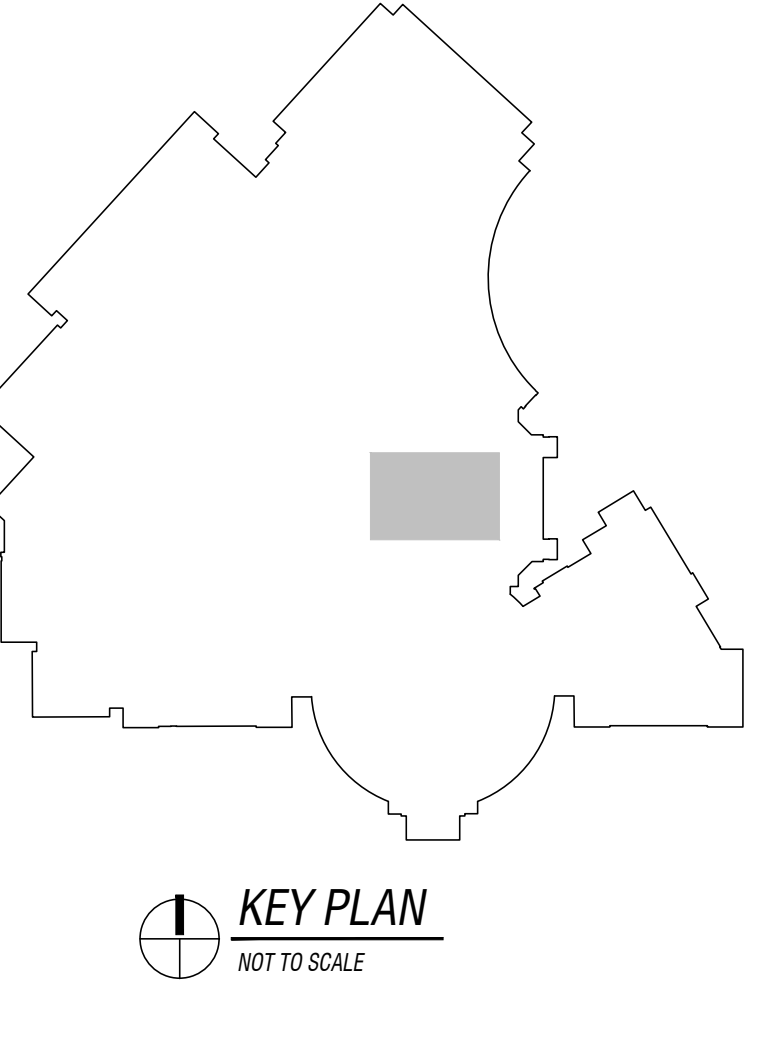

0 16 32 48 0 8 16 24 32 0 4 8 12 0 2 4 6 0 1 2 3 0 1 2 3  
 SCALE: 1/16" = 1'-0" SCALE: 3/32" = 1'-0" SCALE: 1/8" = 1'-0" SCALE: 1/4" = 1'-0" SCALE: 1/2" = 1'-0" SCALE: 3/4" = 1'-0" SCALE: 1" = 1'-0"

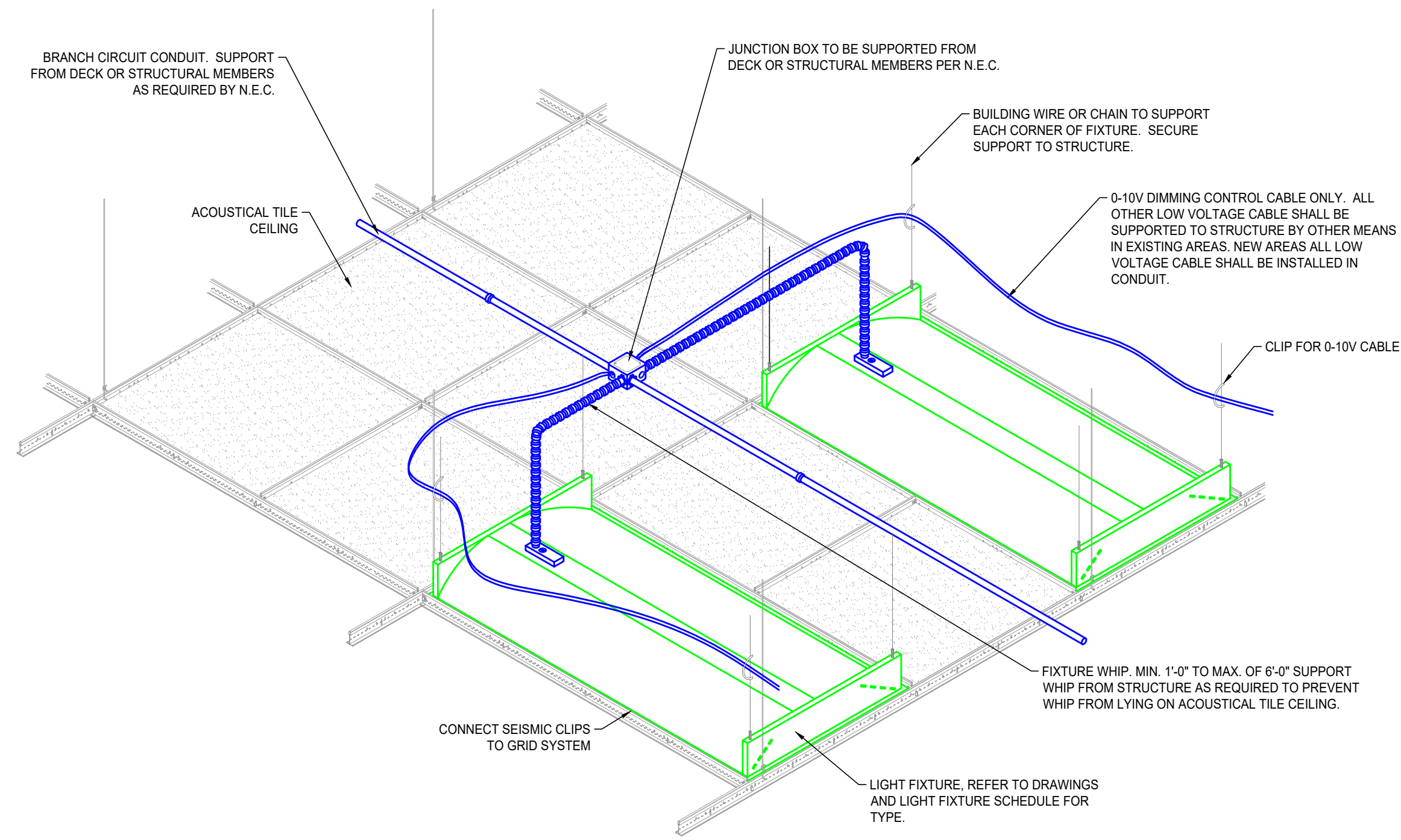

1 RECESSED LIGHT FIXTURE SUPPORT DETAIL  
NOT TO SCALE

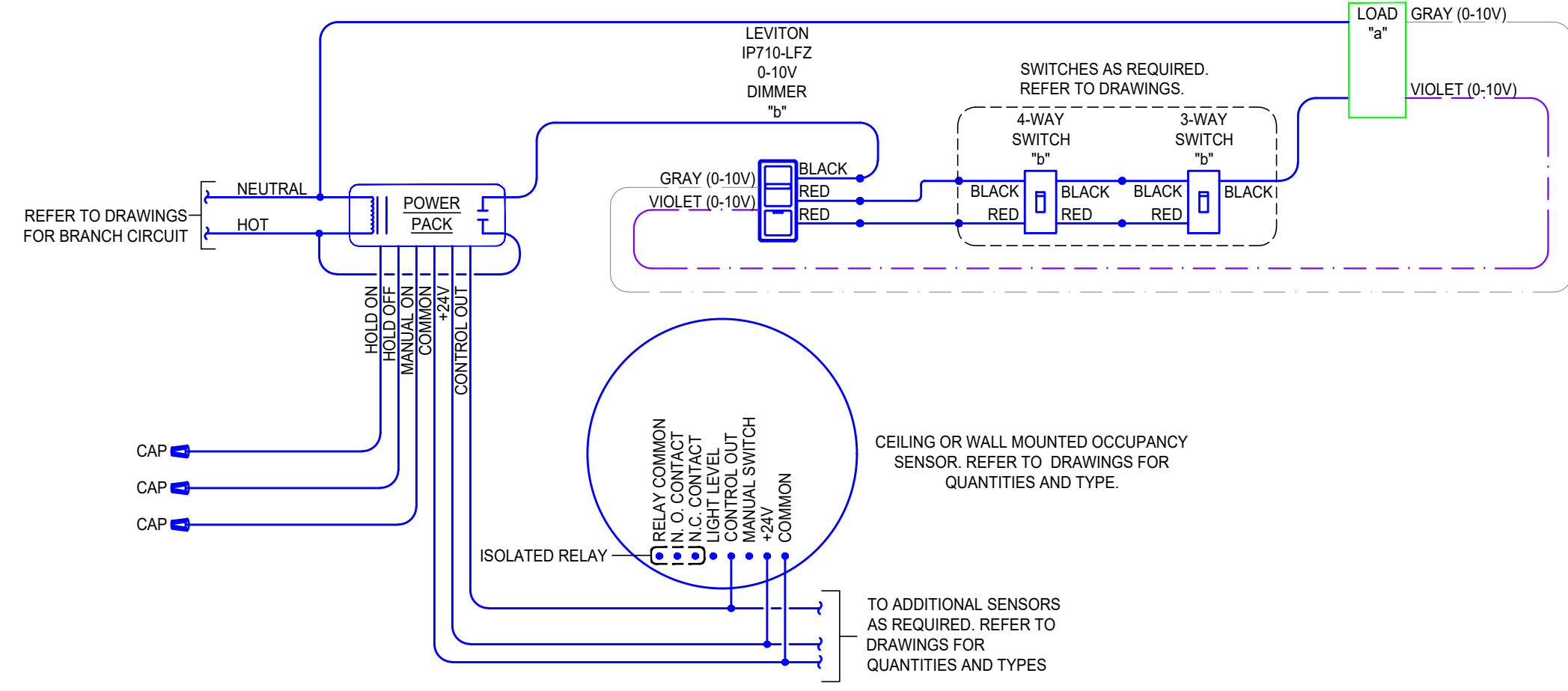

- CONTROL AND OPERATION NOTES:
1. INSTALLATION SHALL PROVIDE AUTOMATIC "ON" AND AUTOMATIC "OFF" OPERATION WITH MANUAL OVERRIDE.
  2. LOW VOLTAGE CABLING SHALL BE MIN #18 AWG CONDUCTORS.
  3. PROVIDE AND INSTALL SECONDARY POWER PACKS, AS REQUIRED, TO PROVIDE ADDITIONAL 0-10VDC POWER FOR SENSORS AND SWITCHES.

2 OCCUPANCY SENSOR WIRING DIAGRAM WITH DIMMING MANUAL OVERRIDE SWITCH  
NOT TO SCALE

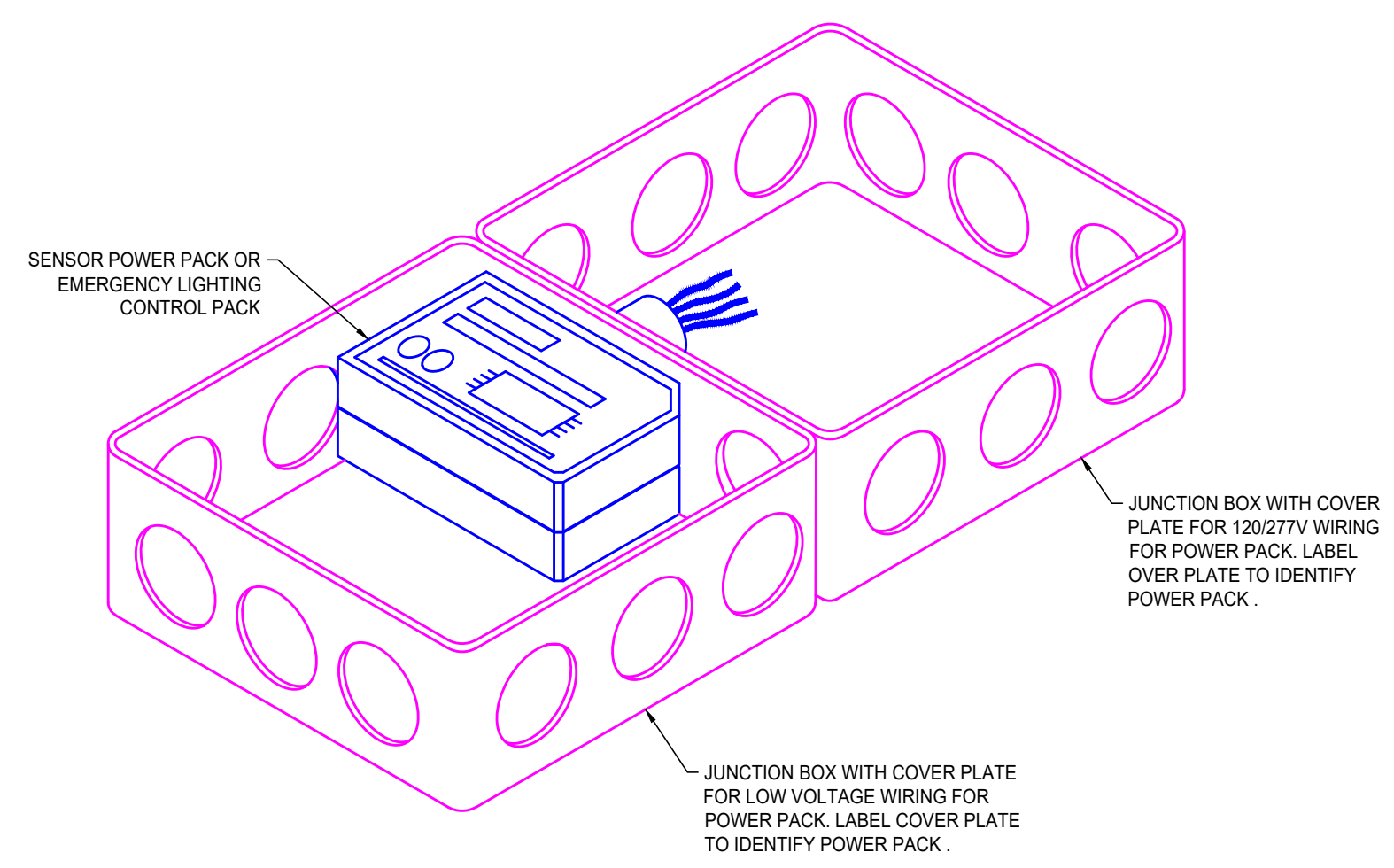

3 POWER PACK MOUNTING DETAIL  
NOT TO SCALE

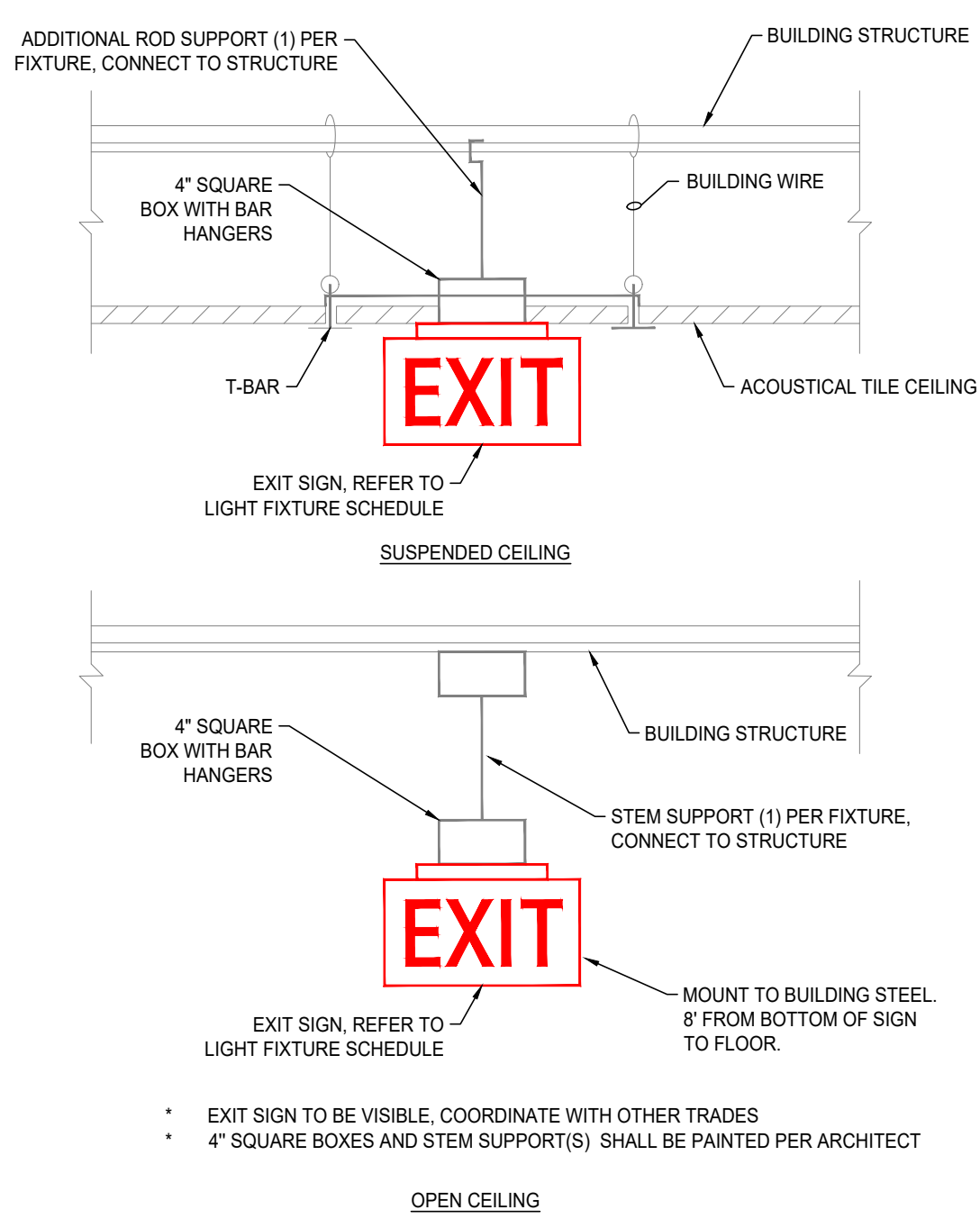

4 EXIT SIGN MOUNTING DETAIL  
NOT TO SCALE

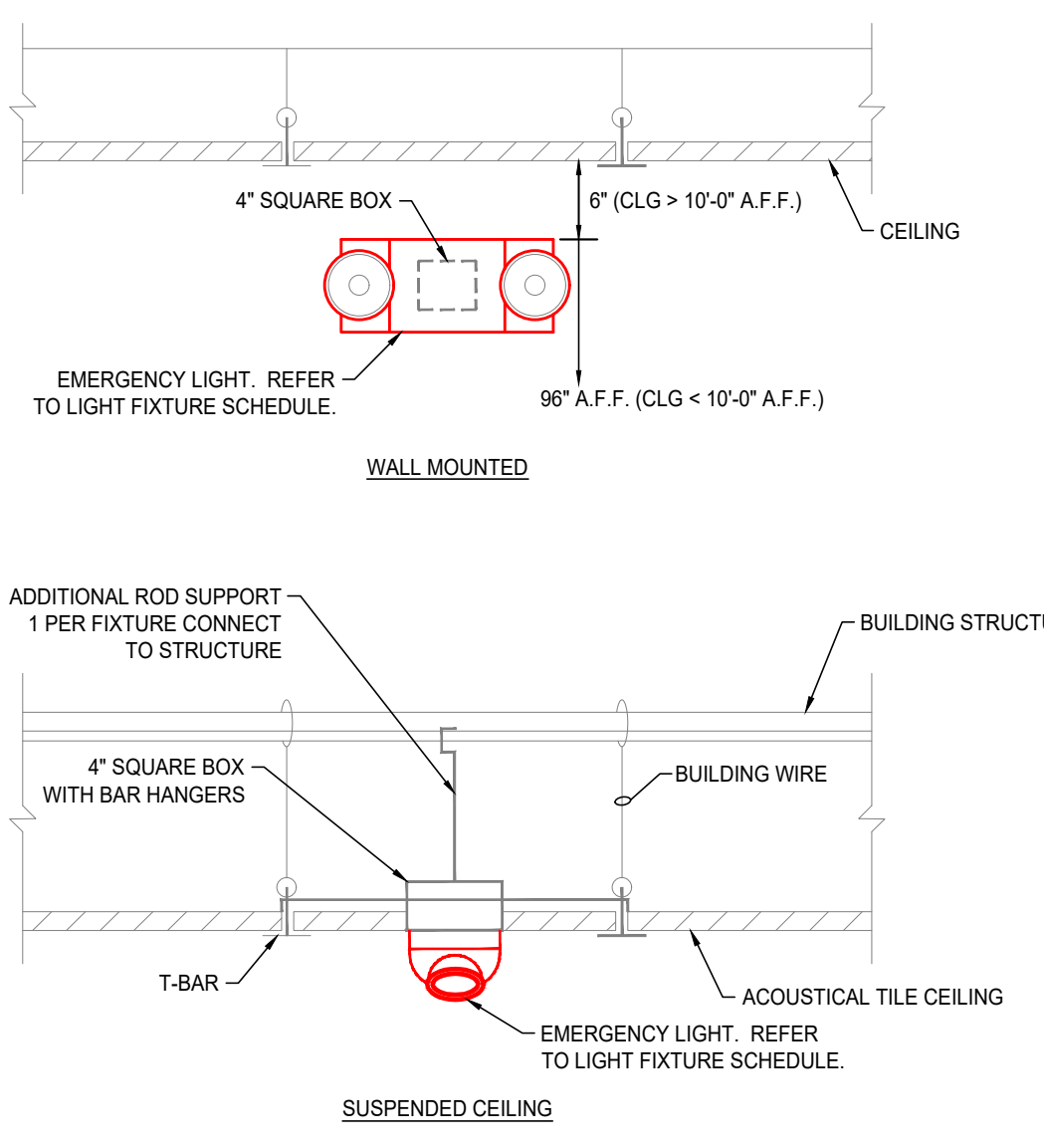

5 EMERGENCY LIGHT MOUNTING DETAIL  
NOT TO SCALE

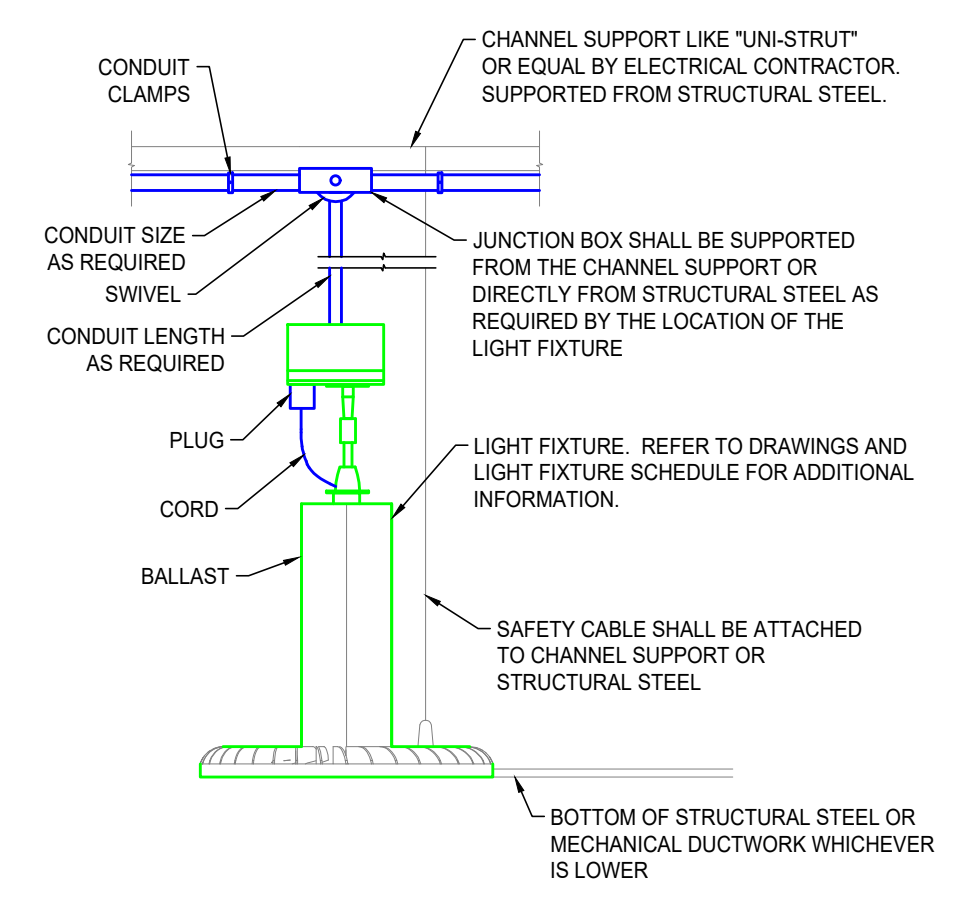

6 HI-BAY FIXTURE MOUNTING (LED)  
NOT TO SCALE

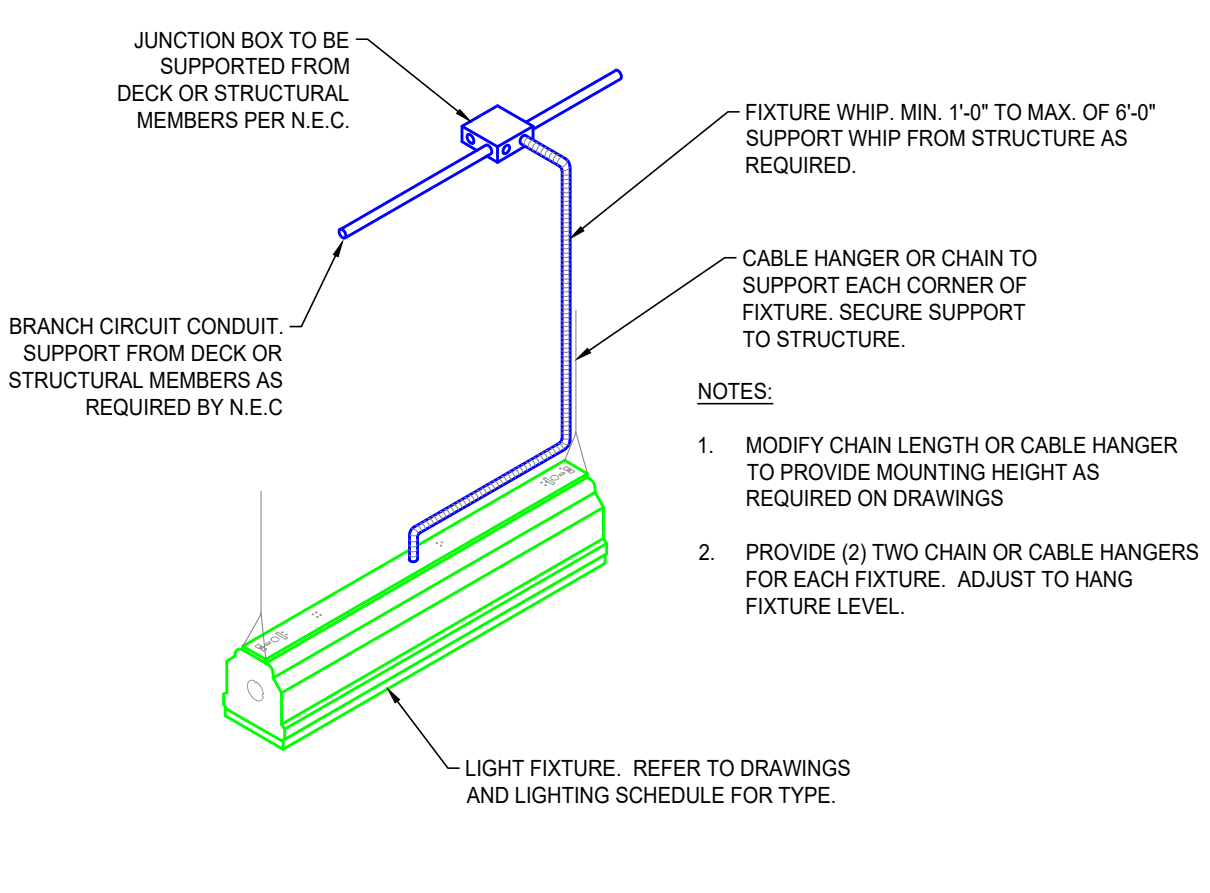

7 STRIP LIGHT FIXTURE SUPPORT DETAIL  
NOT TO SCALE

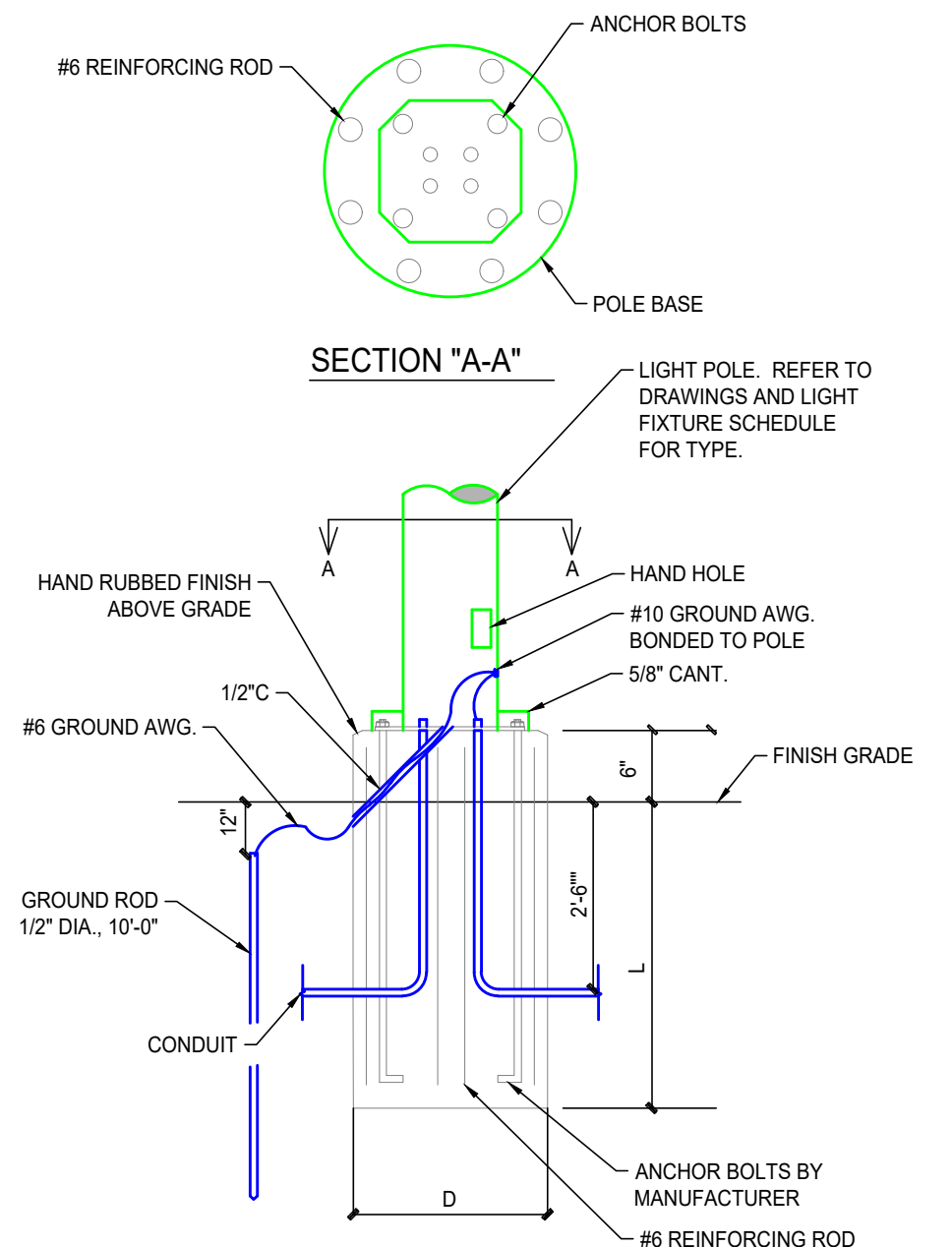

8 6\"/>

CONCRETE BASE DIMENSIONS		
POLE HT	L	D
12'-0"	4'-6"	1'-6"
15'-0"	5'-6"	2'-0"
20'-0"	5'-6"	2'-6"
30'-0"	6'-0"	3'-0"
40'-0"	7'-0"	3'-6"

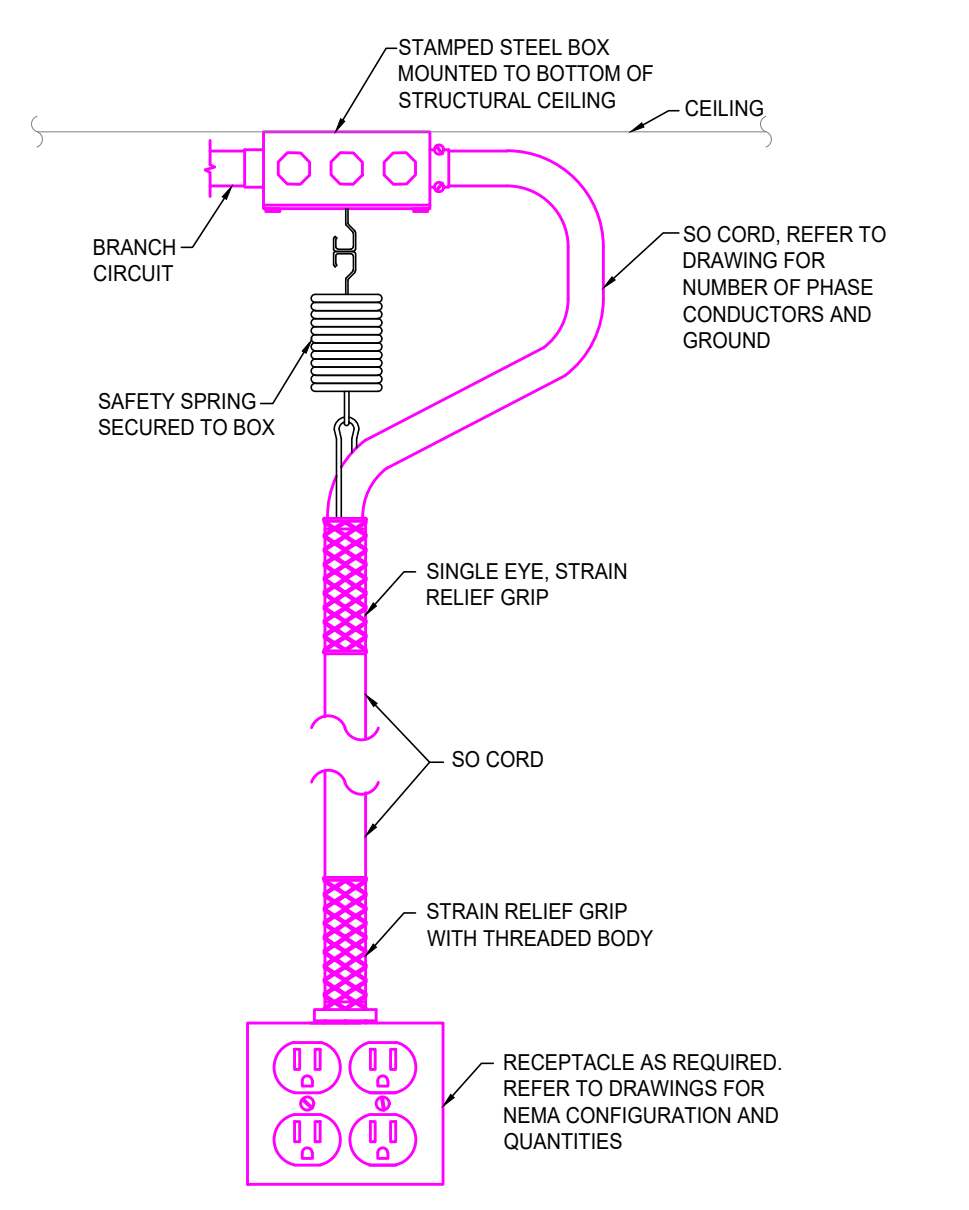

9 TYPICAL POWER CORD DROP DETAIL  
NOT TO SCALE

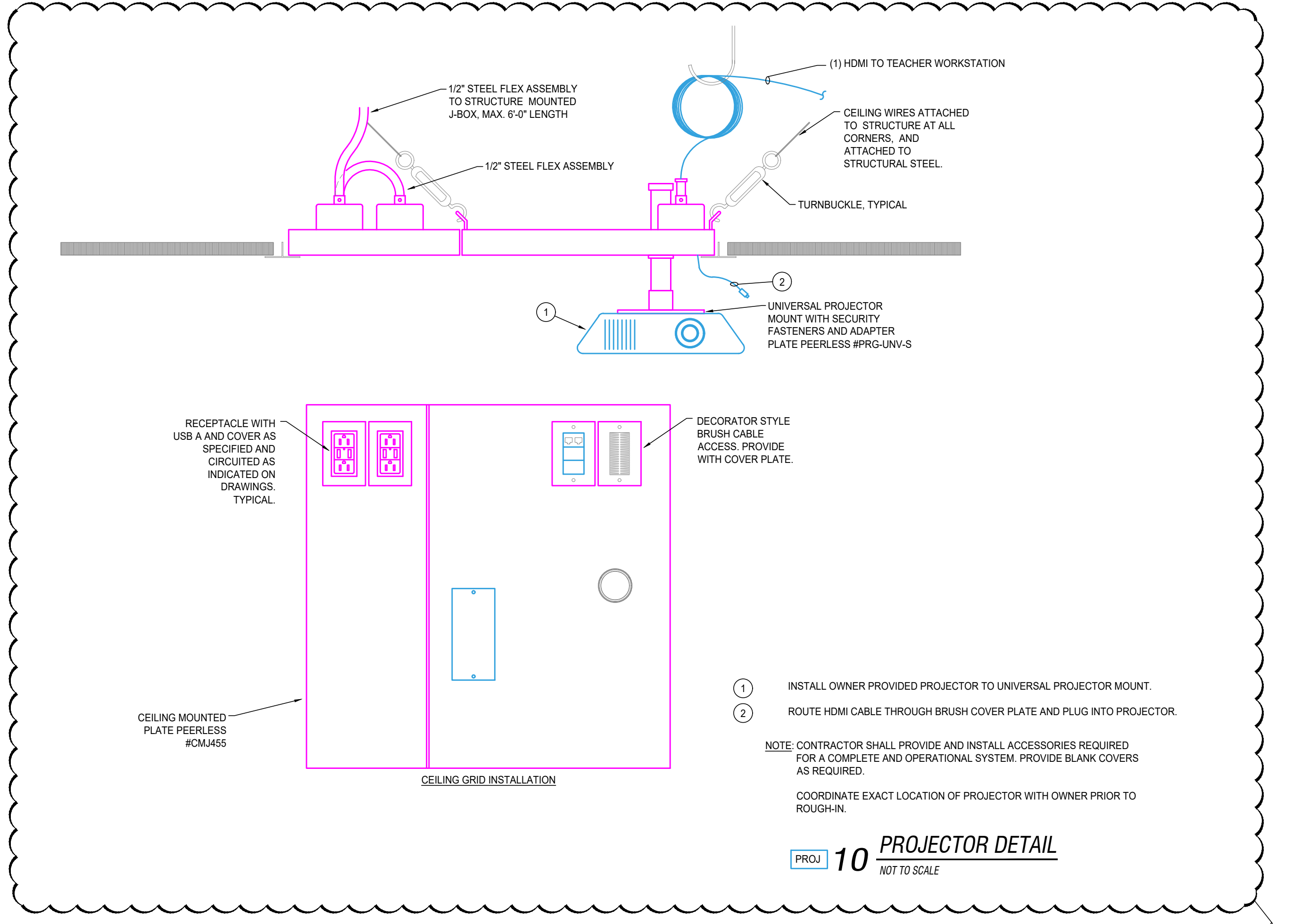

1. INSTALL OWNER PROVIDED PROJECTOR TO UNIVERSAL PROJECTOR MOUNT.
  2. ROUTE HDMI CABLE THROUGH BRUSH COVER PLATE AND PLUG INTO PROJECTOR.
- NOTE: CONTRACTOR SHALL PROVIDE AND INSTALL ACCESSORIES REQUIRED FOR A COMPLETE AND OPERATIONAL SYSTEM. PROVIDE BLANK COVERS AS REQUIRED.
- COORDINATE EXACT LOCATION OF PROJECTOR WITH OWNER PRIOR TO ROUGH-IN.

PROJ 10 PROJECTOR DETAIL  
NOT TO SCALE

All concepts, ideas, plans, and details as shown on this document are the sole property of Primary Engineering, Inc. and shall not be used for any other purpose without their expressed written consent. The project owner shall be permitted to retain copies for information and reference purposes.  
© 2024 Primary Engineering, Inc.

ADDENDUM #2 12-12-2024



**FORT WAYNE COMMUNITY SCHOOLS**  
**2025 Physical Plant Improvements**  
Electrical PPI Projects  
Fort Wayne, Indiana

CERTIFICATION:  
Professional Engineer  
No. PE10302391  
STATE OF INDIANA

DATE: 11-25-2024  
COMM: 24664  
FILE: 664-9-E401  
SCHOOL:

TITLE:  
**ELECTRICAL DETAILS**

SHEET:  
**E401**

