

ADDENDUM NO. 1

Pike Performing Arts Center – Stage Lighting Upgrade  
Pike Performing Arts Center – Speaker Replacement

Project No. 222116.06/222116.07

MSD of Pike Township  
Indianapolis, Indiana

Index of Contents

Addendum No. 1, 5 Items, 3 pages  
New Project Manual Section: 01 23 00 – Alternates  
Revised Project Manual Section: 00 41 16 – BID FORM  
Revised Drawing Sheets – Pike High School PAC Sound Replacement: AV201, AV202, AV300, AV400, and  
AV600  
Pre-Bid Meeting Sign-in Sheet  
Pre-Bid Meeting Agenda

Date: February 22, 2024

FANNING/HOWEY ASSOCIATES, INC.  
ARCHITECTS/ENGINEERS/CONSULTANTS

TO: ALL BIDDERS OF RECORD

ADDENDUM NO. 1 to Drawings and Project Manual, dated February 6, 2024, for MSD of Pike Township, 3950 W. 56<sup>th</sup> Street, Indianapolis, Indiana 46278; as prepared by Fanning/Howey Associates, Inc., Indianapolis, Indiana.

This Addendum shall hereby be and become a part of the Contract Documents the same as if originally bound thereto.

The following clarifications, amendments, additions, revisions, changes, and modifications change the original Contract Documents only in the amount and to the extent hereinafter specified in this Addendum.

Each bidder shall acknowledge receipt of this Addendum in his proposal or bid.

NOTE: Bidders are responsible for becoming familiar with every item of this Addendum. (This includes miscellaneous items at the very end of this Addendum.)

RE: ALL BIDDERS

ITEM NO. 1. PROJECT MANUAL, TABLE OF CONTENTS

- A. Page 00 01 10-1, DIVISION 01: Add Section 01 23 00 - Alternates.

ITEM NO. 2. NEW PROJECT MANUAL SECTION

- A. New Project Manual Section 01 23 00 – Alternates is included with and hereby made a part of this Addendum.

ITEM NO. 3. PROJECT MANUAL, SECTION 00 41 16 – BID FORM

- A. The Bid Form has been revised for this Project. This revised form, dated 2/22/24, is the applicable form to be used by all bidders and is included with and hereby made a part of this Addendum. Revision includes the addition of Base Bid A: Alternates A – K.

These revisions will be reflected on the Bid Forms provided for the convenience of the bidders.

ITEM NO. 4. PROJECT MANUAL, SECTION 26 55 61 – THEATRICAL LIGHTING AND CONTROLS

- A. Replace 1.2, B., 5., a., as follows:

“a. ETC Ion XE 20 12k or Vari-Lite Neo X15.”

- B. Replace 1.2, B., 6., a., and b., as follows:

- “a. ETC Ion XE 20 or Vari-Lite Neo Compact 10 with fader wing.  
b. One (1), touch screen monitor.”

- C. Replace 1.2, C., 1., as follows:

- “1. Theatrical Alternate A: Performing Arts Center.  
a. ETC/High End Systems Road Hog 4 or Vari-Lite Neo X5 in lieu of ETC Ion XE 20 12k.  
b. Provide console with two (2) touchscreens, keyboard and mouse.

- D. Replace 1.2, C., 2., as follows:
- “2. Theatrical Alternate B: Not Used.
- E. Replace 2.3, C., 2., as follows:
- “2. Electronic Theater Controls: Model: Source Four LED Series 3 with XDLT lens tubes.”
- F. Replace 2.7, B., 3., as follows:
- “3. (2), The Light Source “Mega-Claw” or equivalent.”
- G. Replace 2.7, C., 2., as follows:
- “2. Electronic Theater Controls: Model: Halcyon Gold.”
- H. Replace 2.8, B., 3., as follows:
- “3. (2), The Light Source “Mega-Claw” or equivalent.”
- I. Replace 2.9, B., 3., as follows:
- “3. (2), The Light Source “Mega-Claw” or equivalent.”
- J. Replace 2.10, B., 3., as follows:
- “3. (2), The Light Source “Mega-Claw” or equivalent.”
- K. Replace 2.11, B., 1., as follows:
- “1. Manufacturer’s standard power cable with Edison connector.”
- L. Replace 2.11, B., 2., as follows:
- “2. Stand.”
- M. Delete 2.11, B., 3., and 4., in their entirety.
- N. Add 2.11, B., C., 3., as follows:
- “3. Canto USA: Model: Aurora X1 Short.”
- O. Add 2.13, D., 4., as follows:
- “4. TMB”
- P. Replace 2.14, A., as follows:
- “A. 20 amp stage pin for all fixture power cables except for LED followspots.”
- Q. Replace 3.3, A., and B., as follows:
- “A. Unpack, assemble, and hang fixtures at designated locations. Documents will be provided by A/E Consultant.”
- B. Set DMX addresses and personalities (portable theatrical LED fixtures). Address and personality information will be provided by A/E Consultant.”

R. Add 3.4, G., as follows:

“G. No changes to architectural controls are required.”

S. Add 3.7, G., as follows:

“G. Training: Provide a total of 12 hours of training. Six hours to be provided at completion of project. Three hours to be provided not less than 2 months nor more than 4 months following completion. Final 3 hours to be provided not less than 4 months nor more than 6 months following completion.”

ITEM NO. 5. REVISED DRAWING SHEETS – PIKE HIGH SCHOOL – PAC SOUND REPLACEMENT

A. Drawing Sheets: AV201, AV202, AV300, AV400, and AV600 have been revised, dated 2/22/24, and are included with and hereby made a part of this Addendum. These Drawings supersede the original documents.

END OF ADDENDUM

**DOCUMENT 00 41 16 - CONTRACTOR'S BID FOR PUBLIC WORKS – FORM 96**

**PART I**

(To be completed for all bids. Please type or print)

Date: \_\_\_\_\_

1. Governmental Unit (Owner): \_\_\_\_\_
2. County: \_\_\_\_\_
3. Bidder (Firm): \_\_\_\_\_  
Address: \_\_\_\_\_  
City/State/Zip: \_\_\_\_\_
4. Telephone Number: \_\_\_\_\_
5. Agent of Bidder (if applicable): \_\_\_\_\_

Pursuant to notices given, the undersigned offers to furnish labor and materials necessary to complete the public works project of the Pike Performing Arts Center – Stage Lighting Upgrade and Speaker Replacement for MSD Pike Township (Governmental Unit) in accordance with plans and specifications prepared by Fanning Howey Associates, Inc., Indianapolis, Indiana and dated February 6, 2024:

BASE BID A: STAGE LIGHTING UPGRADE

For the sum of \_\_\_\_\_  
(sum in words)

DOLLARS \$ \_\_\_\_\_  
(sum in figures)

BASE BID B: SPEAKER REPLACEMENT

For the sum of \_\_\_\_\_  
(sum in words)

DOLLARS \$ \_\_\_\_\_  
(sum in figures)

**COMBINED BIDS:** Any bidders desiring to submit a combined bid for two or more Base Bid Areas of Work within the same Base Bid Description Area shall so indicate below, together with each Base Bid Area included in the Combined Bid. Refer to Instructions To Bidders for requirements regarding Combined Bids.

<u>BASE BID AREAS INCLUDED</u>	<u>\$ TOTAL AMOUNT OF COMBINED BID</u>
NOTE: For each Base Bid Area of the combined bid, price for every single Base Bid and all alternatives of those Base Bids must be indicated on the previous Bid Form sheets.	BIDDER: Will you accept an award based on any one or more of the Base Bids included in the above Combined Bid? Yes _____ No _____

Bidder has reviewed the Construction Schedule and the intent of the schedule can be met.

<u>Yes</u>	<u>No</u>
------------	-----------

**ALTERNATE BIDS**

***If awarded a Contract for the Work, the undersigned also proposes to furnish or to omit labor and material necessary to complete work as required by the following "Alternate Bids". Should the Bidder awarded the work fail to fill in an Alternate Price and later it is found that the contracted work is affected by the Alternate, the Contractor will be required to perform the work for no change in Contract Price.***

**\*\*MARK "ADD" OR "DEDUCT" FOR EACH ALTERNATE\*\***

**Base Bid A: Alternate Bid A: ETC/High End System Road Hog 4 or Vari-Lite Neo X5.**

Change the Base Bid the sum of \_\_\_\_\_  
(sum in words)

_____ DOLLARS (\$_____)	<b>ADD</b>
(sum in figures)	<b>DEDUCT</b>

**Base Bid A: Alternate Bid B: Not Used.**

Change the Base Bid the sum of \_\_\_\_\_  
(sum in words)

_____ DOLLARS (\$_____)	<b>ADD</b>
(sum in figures)	<b>DEDUCT</b>

**Base Bid A: Alternate Bid C: Performing Arts Center - (10) LED Ellipsoidal spotlights.**

Change the Base Bid the sum of \_\_\_\_\_  
(sum in words)  
\_\_\_\_\_ DOLLARS (\$ \_\_\_\_\_)  
(sum in figures) ADD  
DEDUCT

**Base Bid A: Alternate Bid D: Performing Arts Center – (24) LED ellipsoidal spotlights.**

Change the Base Bid the sum of \_\_\_\_\_  
(sum in words)  
\_\_\_\_\_ DOLLARS (\$ \_\_\_\_\_)  
(sum in figures) ADD  
DEDUCT

**Base Bid A: Alternate Bid E: Performing Arts Center – (44) LED PAR fixtures.**

Change the Base Bid the sum of \_\_\_\_\_  
(sum in words)  
\_\_\_\_\_ DOLLARS (\$ \_\_\_\_\_)  
(sum in figures) ADD  
DEDUCT

**Base Bid A: Alternate Bid F: Performing Arts Center – (9) LED large cyclorama wash fixtures.**

Change the Base Bid the sum of \_\_\_\_\_  
(sum in words)  
\_\_\_\_\_ DOLLARS (\$ \_\_\_\_\_)  
(sum in figures) ADD  
DEDUCT

**Base Bid A: Alternate Bid G: Performing Arts Center – (4) LED large moving profile fixtures and (2) large moving wash fixtures.**

Change the Base Bid the sum of \_\_\_\_\_  
(sum in words)  
\_\_\_\_\_ DOLLARS (\$ \_\_\_\_\_)  
(sum in figures) ADD  
DEDUCT

**Base Bid A: Alternate Bid H: Performing Arts Center – (2) LED followspots.**

Change the Base Bid the sum of \_\_\_\_\_  
(sum in words)  
\_\_\_\_\_ DOLLARS (\$ \_\_\_\_\_)  
(sum in figures) ADD  
DEDUCT

**Base Bid A: Alternate Bid I: Studio Theater – (12) LED medium moving profile fixtures.**

**Change the Base Bid the sum of** \_\_\_\_\_  
(sum in words)

\_\_\_\_\_ **DOLLARS (\$** \_\_\_\_\_ **)**  
(sum in figures) **ADD**  
**DEDUCT**

**Base Bid A: Alternate Bid J: Studio Theater – (6) LED medium moving wash fixtures.**

**Change the Base Bid the sum of** \_\_\_\_\_  
(sum in words)

\_\_\_\_\_ **DOLLARS (\$** \_\_\_\_\_ **)**  
(sum in figures) **ADD**  
**DEDUCT**

**Base Bid A: Alternate Bid K: Studio Theater – (5) LED cyclorama wash fixtures.**

**Change the Base Bid the sum of** \_\_\_\_\_  
(sum in words)

\_\_\_\_\_ **DOLLARS (\$** \_\_\_\_\_ **)**  
(sum in figures) **ADD**  
**DEDUCT**

#### PROPOSAL TIME

Bidder agrees that this Bid shall remain in force for a period of sixty (60) consecutive calendar days from the due date, and Bids may be accepted or rejected during this period. Bids not accepted within said 60 consecutive calendar days shall be deemed rejected.

The undersigned acknowledges receipt of the following Addenda:

Receipt of Addenda No(s). \_\_\_\_\_

Attended pre-bid conference	YES	NO
-----------------------------	-----	----

Has visited the jobsite	YES	NO
-------------------------	-----	----

The undersigned further agrees to furnish a bond or certified check with this Bid for an amount specified in the notice of the letting. If alternate bids apply, the undersigned submits a proposal for each in accordance with the notice. Any addenda attached will be specifically referenced at the applicable page.

If additional units of material included in the contract are needed, the cost of units must be the same as that shown in the original contract if accepted by the governmental unit. If the bid is to be awarded on a unit basis, the itemization of the units shall be shown on a separate attachment.



The contractor and his subcontractors, if any, shall not discriminate against or intimidate any employee, or applicant for employment, to be employed in the performance of this contract, with respect to any matter directly or indirectly related to employment because of race, religion, color, sex, national origin or ancestry. Breach of this covenant may be regarded as a material breach of the contract.

CERTIFICATION OF USE OF UNITED STATES STEEL PRODUCTS  
(If applicable)

I, the undersigned Bidder or agent as a Contractor on a public works project, understand my statutory obligation to use steel products made in the United States (I.C. 5-16-8-2). I hereby certify that I and all subcontractors employed by me for this Project will use U.S. steel products on this Project if awarded. I understand that violations hereunder may result in forfeiture of contractual payments.

## ACCEPTANCE

The above bid is accepted this \_\_\_\_\_ day of \_\_\_\_\_, \_\_\_\_\_, subject to the following conditions: \_\_\_\_\_

Contracting Authority Members:

_____	_____
_____	_____
_____	_____

## PART II

(For projects of \$100,000 or more – IC 36-1-12-4)

Governmental Unit: \_\_\_\_\_

Bidder (Firm): \_\_\_\_\_

Date: \_\_\_\_\_

These statements to be submitted under oath by each Bidder with and as a part of his bid. Attach additional pages for each section as needed.

## SECTION I - EXPERIENCE QUESTIONNAIRE

1. What public works projects has your organization completed for the period of one (1) year prior to the date of the current bid?

Contract Amount	Class of Work	Completion Date	Name and Address of Owner

2. What public works projects are now in process of construction by your organization?

Contract Amount	Class of Work	Expected Completed Date	Name and Address of Owner

3. Have you ever failed to complete any work awarded to you? \_\_\_\_\_ If so, where and why?

---

---

---

---

4. List references from private firms for which you have performed work.

---

---

---

---

## **SECTION II - PLAN AND EQUIPMENT QUESTIONNAIRE**

1. Explain your plan or layout for performing proposed Work. (Examples could include a narrative of when you could begin work, complete the project, number of workers, etc. and any other information which you believe would enable the governmental unit to consider your bid.)
2. Please list the names and addresses of all subcontractors (i.e. persons or firms outside your own firm who have performed part of the work) that you have used on public works projects during the past five (5) years along with a brief description of the work done by each subcontractor.
3. If you intend to sublet any portion of the Work, state the name and address of each subcontractor, equipment to be used by the subcontractor, and whether you will require a bond. However, if you are unable to currently provide a listing, please understand a listing must be provided prior to contract approval. Until the completion of the proposed project, you are under a continuing obligation to immediately notify all governmental unit in the event that you subsequently determine that you will use a subcontractor on the proposed project.
4. What equipment do you have available to use for the proposed project? Any equipment to be used by subcontractors may also be required to be listed by the governmental unit.
5. Have you entered into contracts or received offers for all materials which substantiate the prices used in preparing your proposal? If not, please explain the rationale used which would corroborate the prices listed.

## **SECTION III CONTRACTOR'S FINANCIAL STATEMENT**

Attachment of Bidder's financial statement is mandatory. Any Bid submitted without said financial statement as required by statute shall thereby be rendered invalid. The financial statement provided hereunder to the governing body awarding the Contract must be specific enough in detail so that said governing body can make a proper determination of the Bidder's capability for completing the Project if awarded.

#### SECTION IV – CONTRACTOR'S NON-COLLUSION AFFIDAVIT

The undersigned bidder or agent, being duly sworn on oath, says that he has not, nor has any other member, representative, or agent of the firm, company, corporation or partnership represented by him, entered into any combination, collusion or agreement with any person relative to the price to be bid by anyone at such letting nor to prevent any person from bidding nor to include anyone to refrain from bidding, and that this bid is made without reference to any other bid and without any agreement, understanding or combination with any other person in reference to such bidding.

He further says that no person or persons, firms or corporation has, have or will receive directly or indirectly, any rebate, fee, gift, commission or thing of value on account of such sale.

#### SECTION V OATH AND AFFIRMATION

I HEREBY AFFIRM UNDER THE PENALTIES OF PERJURY THAT THE FACTS AND INFORMATION CONTAINED IN THE FOREGOING BID FOR PUBLIC WORKS ARE TRUE AND CORRECT.

Dated at \_\_\_\_\_ this \_\_\_\_\_ day of \_\_\_\_\_, \_\_\_\_\_

\_\_\_\_\_  
(Name of Organization)

By \_\_\_\_\_

\_\_\_\_\_  
(Title of Person Signing)

#### ACKNOWLEDGEMENT

STATE OF \_\_\_\_\_ )  
COUNTY OF \_\_\_\_\_ )SS:

Before me, a Notary Public, personally appeared the above-named \_\_\_\_\_  
and swore that the statements contained in the foregoing document are true and correct.

Subscribed and sworn to before me this \_\_\_\_\_ day of \_\_\_\_\_, 20\_\_\_\_\_.

\_\_\_\_\_  
Notary Public

My Commission Expires: \_\_\_\_\_

County of Residence: \_\_\_\_\_

BIDDER REMINDER LIST TO BE COMPLETED AND INCLUDED  
IN BID PACKAGE FOR REVIEW AT BID OPENING

	YES	NO
Have you properly and completely executed the Form No. 96 (Format) Bid Form (Section 004116)?		
Have you included your company's Financial Statement (Part II, Sect. III)?		
Note that the Non-Collusion Affidavit is part of the new Bid Form and is to be notarized.		
Have you enclosed a certified check or Bid Bond? (Note: bond must be signed by Surety and Principal)		
Have you indicated the Project Name, Bid Category No., and Description on the outside of your Bid envelope?		

NOTE: IF ANY OF THE REQUIRED BIDDING DOCUMENTS ARE NOT INCLUDED, DATED, PROPERLY EXECUTED, THE CONTRACTOR'S BID MAY NOT BE ACCEPTED.

END OF DOCUMENT 00 41 16

## SECTION 01 23 00 - ALTERNATES

### PART 1 - GENERAL

#### 1.1 RELATED DOCUMENTS

- A. Drawings and general provisions of Contract, including General Conditions and other Division 01 Specification Sections, apply to this Section.

#### 1.2 SUMMARY

- A. This Section includes administrative and procedural requirements for alternates.

#### 1.3 DEFINITIONS

- A. Alternate: An amount proposed by bidders and stated on Bid Form for certain work defined in Bidding Requirements that may be added to or deducted from Base Bid amount if Owner decides to accept a corresponding change either in quantity of construction to be completed or in products, materials, equipment, systems, or installation methods described in Contract Documents.
  - 1. The cost or credit for each alternate is net addition to or deduction from Contract Sum to incorporate alternate into Work. No other adjustments are made to Contract Sum.
  - 2. Alternates described in this Section are part of Work only if enumerated in Agreement.

#### 1.4 PROCEDURES

- A. Coordination: Modify or adjust affected adjacent work as necessary to completely integrate work of alternate into Project.
  - 1. Include as part of each alternate, miscellaneous devices, accessory objects, and similar items incidental to or required for a complete installation whether or not indicated as part of alternate.
- B. Notification: Immediately following award of Contract, notify each entity involved, in writing, of status of each alternate. Indicate if alternates have been accepted, rejected, or deferred for later consideration. Include a complete description of negotiated modifications to alternates.
- C. Execute accepted alternates under same conditions as other work of Contract.
- D. Schedule: A Schedule of Alternates is included at end of this Section. Specification Sections referenced in schedule contain requirements for materials necessary to achieve work described under each alternate.

### PART 2 - PRODUCTS (Not Used)

### PART 3 - EXECUTION

#### 3.1 SCHEDULE OF ALTERNATES

- A. Base Bid A: Alternate A: Performing Arts Center, Provide ETC/High End Systems Road Hog 4 or Vari-Lite Neo X5 with console including two (2) touchscreens, keyboard and mouse in lieu of ETC Ion XE 20 12k.
- B. Base Bid A: Alternate B: Not Used.
- C. Base Bid A: Alternate C: Provide portable theatrical fixtures for Performing Arts Center, (10) LED ellipsoidal spotlights with 19 degree lenses (splays).

- D. Base Bid A: Alternate D: Provide portable theatrical fixtures for Performing Arts Center, (24) LED ellipsoidal spotlights with 50 degree lenses (stage side lighting).
- E. Base Bid A: Alternate E: Provide portable theatrical fixtures for Performing Arts Center, (44) LED PAR fixtures (stage electrics).
- F. Base Bid A: Alternate F: Provide portable theatrical fixtures for Performing Arts Center, (9) LED large cyclorama wash fixtures (stage electrics).
- G. Base Bid A: Alternate G: Provide portable theatrical fixtures for Performing Arts Center, (4) LED large moving profile fixtures and (2) large moving wash fixtures.
- H. Base Bid A: Alternate H: Provide portable theatrical fixtures for Performing Arts Center, (2) LED followspots.
- I. Base Bid A: Alternate I: Provide portable theatrical fixtures, Studio Theater, (12) LED medium moving profile fixtures.
- J. Base Bid A: Alternate J: Provide portable theatrical fixtures, Studio Theater, (6) LED medium moving wash fixtures.
- K. Base Bid A: Alternate K: Provide portable theatrical fixtures, Studio Theater, (5) LED cyclorama wash fixtures (stage electrics).

END OF SECTION 01 23 00

## **PREBID CONFERENCE AGENDA**

MSD of Pike Township  
Indianapolis, Indiana

Date: February 15, 2024 at 10:00 a.m.

Re: Pike Performing Arts Center Stage Lighting Upgrade  
Pike Performing Arts Center Speaker Replacement  
MSD of Pike Township  
Indianapolis, IN  
Project No. 222116.06 / 222116.07

Present: Refer to attached Prebid Sign-in Sheet

1. Advertisement to Bidders: Per the information contained in the Advertisement to Bidders in the Project Manual, bids will be received until, **10:00 a.m. on February 29, 2024** at the MSD of Pike Township – Administration Services Center, Attn: Director of Facilities & Security, 6901 Zionsville Rd, Indianapolis, IN 46268 in Board Room. Bids will be opened publicly and read aloud immediately after specified closing time. Bids may be held for 60 days.
2. Obtaining Bid Documents: To obtain documents Bidders will be required to register at the Eastern Engineering, 317-598-0661, website ([distribution.easternengineering.com](http://distribution.easternengineering.com)) to become a plan holder for the Project. Once registered, Bidders can download the complete set of documents in .PDF form free of charge. Registered bidders will receive electronic distribution of addendums and other electronic communications during the bidding period. Bidders can purchase hard copies of the documents from Eastern Engineering for the cost of printing as established by the Printer. No partial sets will be issued.
3. Instructions to Bidders: Per the information contained in the Project Manual, Bids shall be executed on the Bid Proposal Form provided. Other information to be included with the bid form is outlined in the Instructions to Bidders. Each bidder is required to bid every item called for on the bid form, including alternates, and allowances.
  - a. Base Bid – Include following amounts in Base Bid for inclusion in Contract Sum:

Base Bid A, Allowance No. 1: \$10,000.00	Contingency Allowance
Base Bid B, Allowance No. 1: \$10,000.00	Contingency Allowance
4. Identification of Submission of Bid Proposal: Per the Instructions to Bidders, the Bid Proposal shall be submitted in an envelope identified with the name of the project, name of the bidder, base bid package, and the date and closing time of bids. Photocopies of the bid form are acceptable. Refer to the checklist in the Instructions to Bidders to make sure all required documents are submitted with the Bid. Be sure to submit the subcontractor and manufacturer lists with the bid.



Prebid Conference Agenda  
Pike Performing Arts Center Stage Lighting Upgrade  
Pike Performing Arts Center Speaker Replacement  
MSD of Pike Township  
Indianapolis, IN  
Project No. 222116.06 / 222116.07  
February 15, 2024 at 10:00 a.m.  
Page 2

5. Bonds: See the Instructions to Bidders and the Advertisement to Bidders for the requirements of bid securities and bonds required. Performance and Payment Bonds are for 100% of the bid.
6. Time of Commencement and Completion of Project: The Board will be asked to award a Contract at the Board Meeting on March 14, 2024 after which a Preconstruction Conference will be scheduled. Start of work on-site can begin on May 31, 2024. Work shall achieve substantial completion by July 22, 2024. The schedule for the Work will be confirmed at the Preconstruction Meeting referenced above.
7. Temporary Facilities and Controls: Information on temporary facilities and controls are listed in Section 015000 of the Project Manual.
8. Addenda: – If required, any addenda will be issued by February 22, 2024.
9. Questions and Clarifications: Per the instructions in the Project Manual, questions should be emailed to the appropriate contact person at Fanning Howey and followed up with a telephone call. Contacts and telephone numbers are listed in the Instruction to Bidders. Questions requiring clarifications or revisions will be addressed in an addendum. Any questions can be directed in writing to Gregg Dixon at [gdixon@fhai.com](mailto:gdixon@fhai.com) and Peter Winters at [pwinters@fhai.com](mailto:pwinters@fhai.com)
10. Permits, Fees, and Notices: All permits, fees, and notices are the responsibility of the Contractor. The building permit for this Project will be secured by the Contractor once the Board awards the Contract.
11. Review of Project Scope / Building Tour:
  - a. Pike Performing Arts Center area.
12. Discussion Items and Questions:
  - a. To be included from pre-bid meeting.

Peter Winters  
Project Manager

Project Name

MSD OF PIKE TOWNSHIP

PIKE PERFORMING ARTS CENTER STAGE LIGHTING UPGRADE  
PIKE PERFORMING ARTS CENTER SPEAKER REPLACEMENT

Project No. 222116.06/222116.07

Meeting Date FEBRUARY 15, 2024

PLEASE PRINT CLEARLY. YOUR NAME AND  
TITLE WILL BE INCLUDED IN THE MEETING  
REPORT.

THANK YOU!

## SIGN-IN SHEET

NAME (Please print)	TITLE	COMPANY	PHONE/ FAX	E-MAIL
Clayton Gruber	Director of Facilities and Security	MSD of Pike Township	317.280.2425	cgruber@pike.k12.in.us
PETER WINTERS	PROJECT MANAGER	FANNING HOWEY	317.410.1289	p.winters@fha.com
Brian Fisher	<del>Account Manager</del>	Force Tech	317-557-2447	beck@force.tech
Alex Moon	Lead Engineer	Force Tech		alex@force.tech
SEAN COLE	Project Manager	ACD	812-360-4088	seale@acdtheatrical.com
Aaron Seelig	Sales Manager	Indy Stage	317 635 9430	aaron@indystage.com
RYAN DAVIES	ETC MANUFACTURE REPRESENTATIVE	CL LIGHTING RIGGING & CONTROLS	773 814 1426	ryan@clights.com
Randy Schuetter	Account Executive	Max Era Technology	317-432-5716	randy.schuetter@neweratech.com
T.R. YELTON	ESTIMATOR	NEW ERA	317-714-1770	tr.yelton@neweratech.com
DAVID WRIGHT	DESIGN - IMEG	IMEG	See Bid Docs	M.D. wright@megcorp.com
Russ Hoppel	Senior designer	IMEG	317-580-6922	russ.c.hoppel@megcorp.com
Gabe Dixon	CA	FH	317-439-4710	gdixon@fha.com

23001750.00 2/22/2024 6:42:45 AM Pike High School Performing Arts Center Renovation



- KEYNOTES:**
1. RELOCATE EXISTING BROWN ACOUSTIC WALL PANELS IDENTIFIED ON SHEET AV101 TO FRONT FACE OF BALCONY. LAYOUT FOR ACOUSTIC PANELS SHOULD BE "BY SHOPS". PROVIDE MOUNTING ACCESSORIES TO RELOCATE EXISTING ACOUSTIC 2 INCH WALL PANELS TO UNDERSIDE OF BALCONY FACE. INCLUDE PATCH AND MORTAR WHERE PANELS ARE REMOVED.
  2. OPEN VERTICAL CAVITY FOR CABLE PATH FROM STAGE TO UPPER STEEL AREA.
  3. FIBER PATHWAY FROM STAGE RACK TO MD1 ROOM K102 IS ABOVE CEILING THROUGH CORRIDOR. ESTIMATED AT 100' IN LENGTH.

Pike High School  
Performing Arts Center  
Renovation

INDIANAPOLIS, INDIANA

FANNING HOWEY



PROFESSIONAL SEAL

KEY PLAN

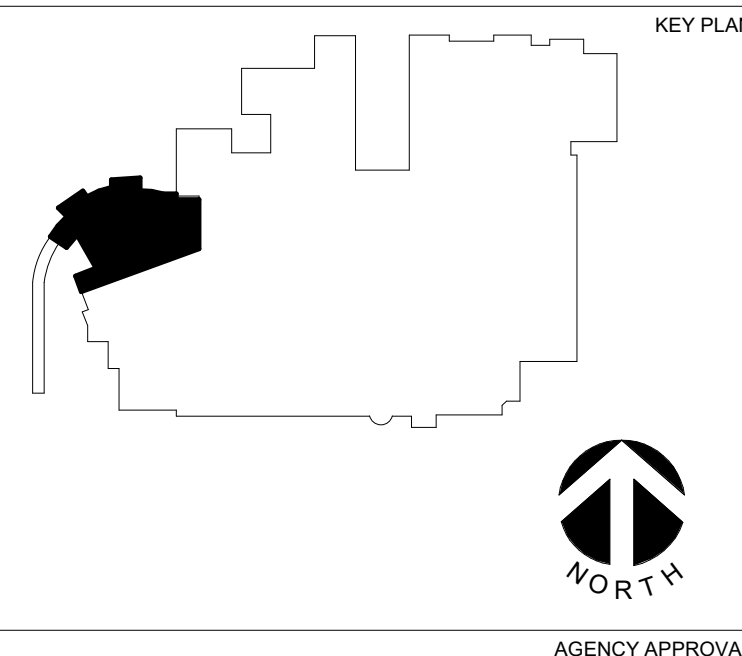

AGENCY APPROVAL

DISCLAIMER

IMEG RESERVES PROPRIETARY RIGHTS, INCLUDING COPYRIGHTS, TO THIS DRAWING AND THE DATA SHOWN THEREON. SAID DRAWING AND/OR DATA ARE THE EXCLUSIVE PROPERTY OF IMEG AND SHALL NOT BE USED OR REPRODUCED FOR ANY OTHER PROJECT WITHOUT THE EXPRESS WRITTEN APPROVAL AND PARTICIPATION OF IMEG. ©2024 IMEG CONSULTANTS CORP.

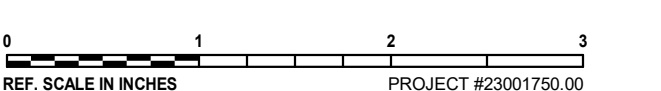

No.	Date	Revision / Issue
1	2/22/2024	Addendum 1

SHEET INFORMATION

Issue	CONSTRUCTION DOCUMENTS
Date	2/6/2024
Project #	23001750.00
Drawn	Author
Checked	Checker
Approved	Approver

SHEET TITLE

FIRST FLOOR PLAN - AV

SCALE

Scale: 1/8" = 1'-0"

SHEET NUMBER

AV201

**FIRST FLOOR PLAN - AV**  
1/8" = 1'-0"



23001750.00 2/22/2024 8:42:46 AM Pike High School Performing Arts Center Renovation

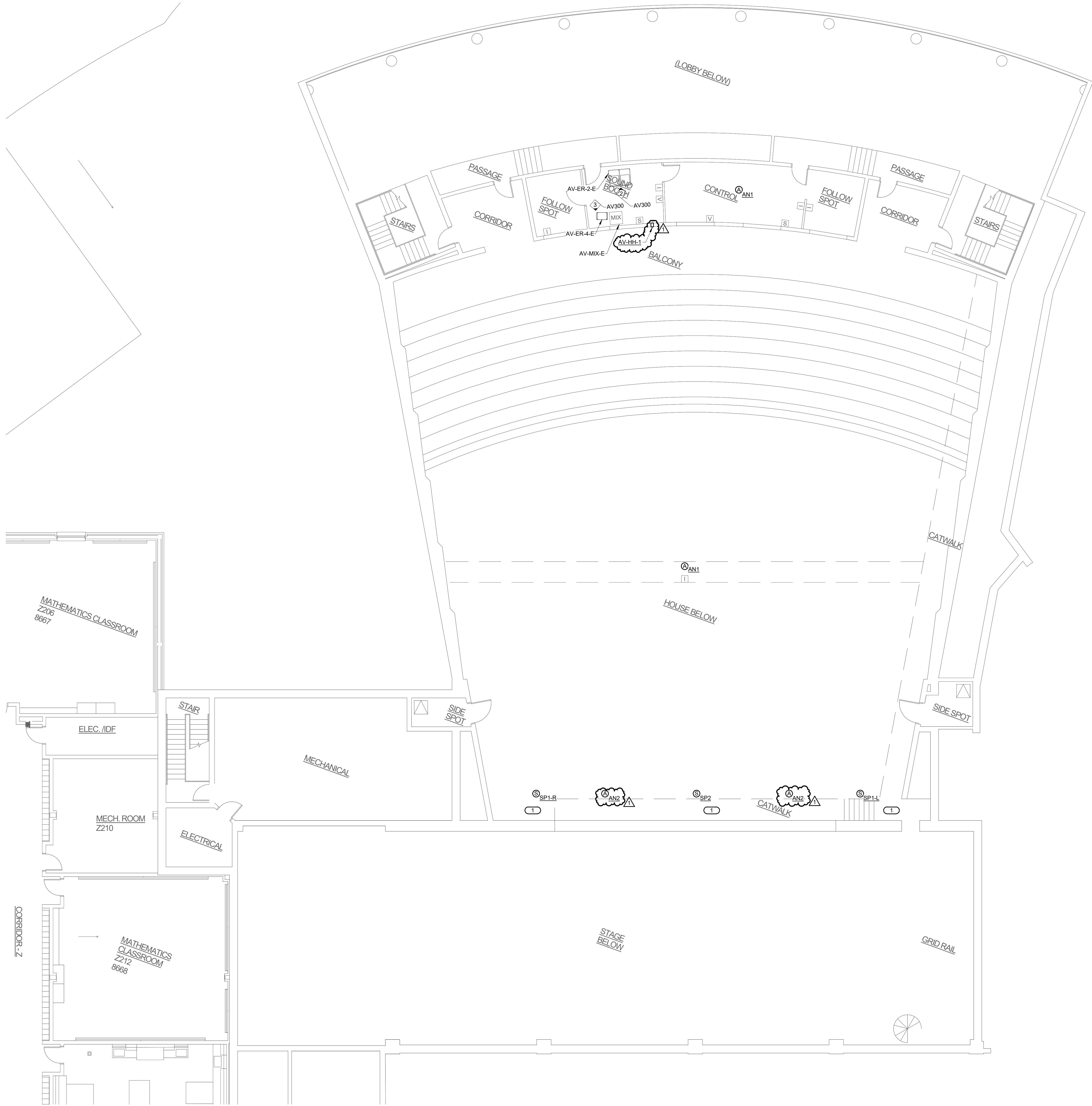

1

SECOND FLOOR PLAN - AV

1/8" = 1'-0"

KEYNOTES: ( # )

1. REFER TO AV500 LOUDSPEAKER AIM SCHEDULE FOR LOUDSPEAKER LOCATIONS. REFER TO DETAIL 2/AV401 FOR INTENDED SUSPENSION PICK POINTS. PROVIDE SUPPLEMENTAL STEEL FOR RIGGING PICK POINT AND INDEPENDANT SAFETY CABLE TO BUILDING STEEL FOR EACH LOUDSPEAKER ARRAY. REFER TO SPECIFICATION 27-41.00 FOR RIGGING AND P.E. REVIEW REQUIREMENTS.

Pike High School  
Performing Arts Center  
Renovation

INDIANAPOLIS, INDIANA

FANNING HOWEY



8900 KEYSTONE CROSSING  
SUITE 210  
INDIANAPOLIS, IN 46240  
P: 317.848.5045 F: 317.844.2201

PROFESSIONAL SEAL

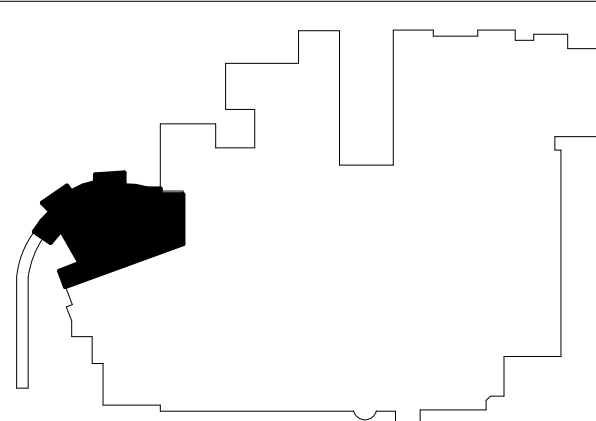

KEY PLAN



AGENCY APPROVAL

DISCLAIMER

IMEG RESERVES PROPRIETARY RIGHTS, INCLUDING COPYRIGHTS, TO THIS DRAWING AND THE DATA SHOWN THEREON. SAID DRAWING AND/OR DATA ARE THE EXCLUSIVE PROPERTY OF IMEG AND SHALL NOT BE USED OR REPRODUCED FOR ANY OTHER PROJECT WITHOUT THE EXPRESS WRITTEN APPROVAL AND PARTICIPATION OF IMEG. ©2024 IMEG CONSULTANTS CORP.

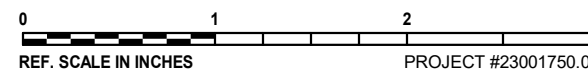

REVISIONS

No.	Date	Revision / Issue
1	2/22/2024	Addendum 1

SHEET INFORMATION

CONSTRUCTION DOCUMENTS	
Issue	2/6/2024
Date	23001750.00
Project #	Author
Drawn	Checker
Checked	Approver
Approved	

SHEET TITLE

SECOND FLOOR PLAN - AV

SCALE

Scale: 1/8" = 1'-0"

SHEET NUMBER

AV202

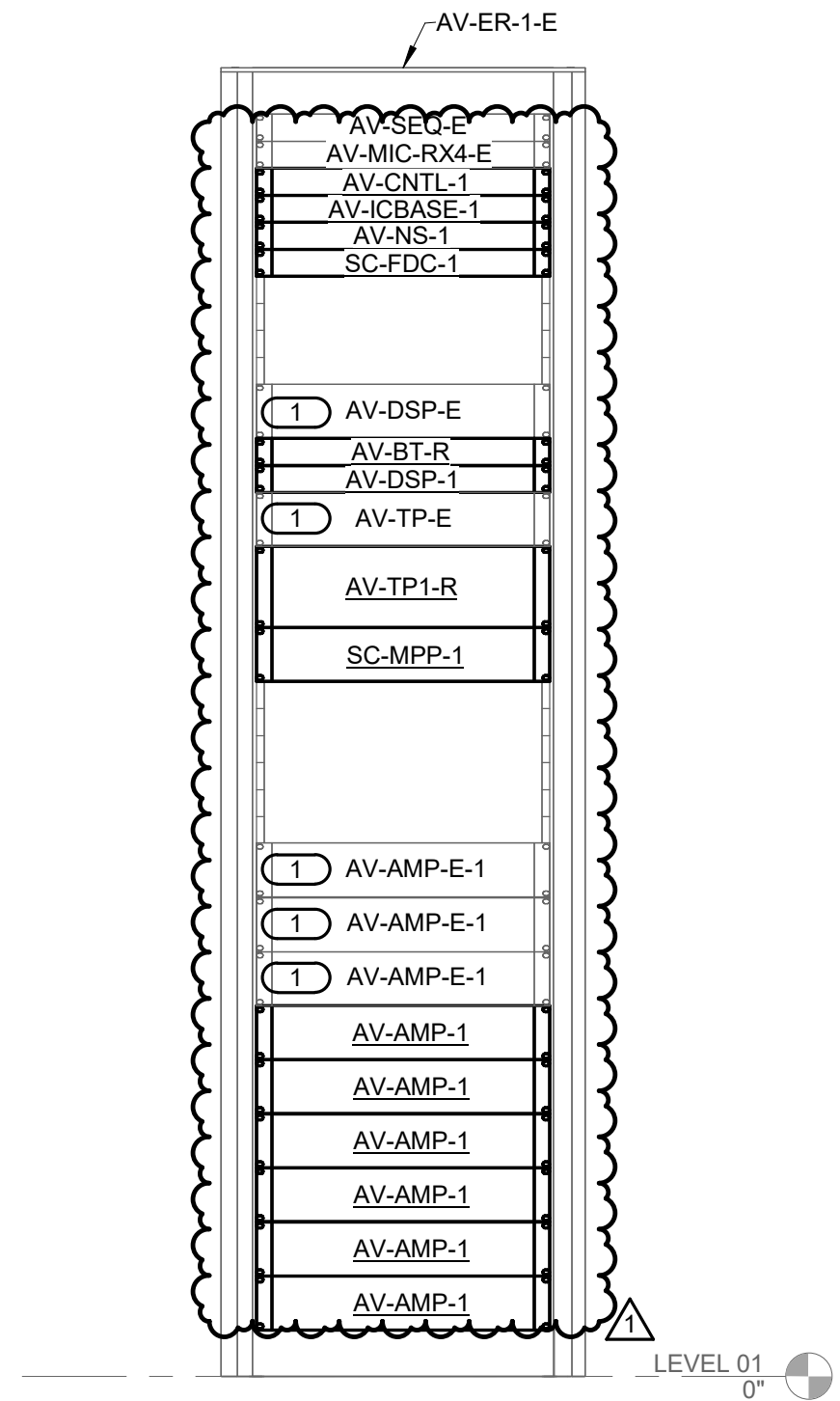

### 1 AV STAGE RACK ELEVATION

- NO SCALE  
NOTES:  
1. LOCATIONS OF NEW AND EXISTING DEVICES SHOWN FOR CONCEPT ONLY. CONTRACTOR TO VERIFY LOCATIONS OF EXISTING EQUIPMENT.  
KEYNOTES: **#**  
1. REMOVE EXISTING DEVICE AND TURN OVER TO OWNER. USE SPACE AVAILABLE AFTER DEMOLITION TO OPTIMIZE LOCATIONS OF NEW EQUIPMENT.

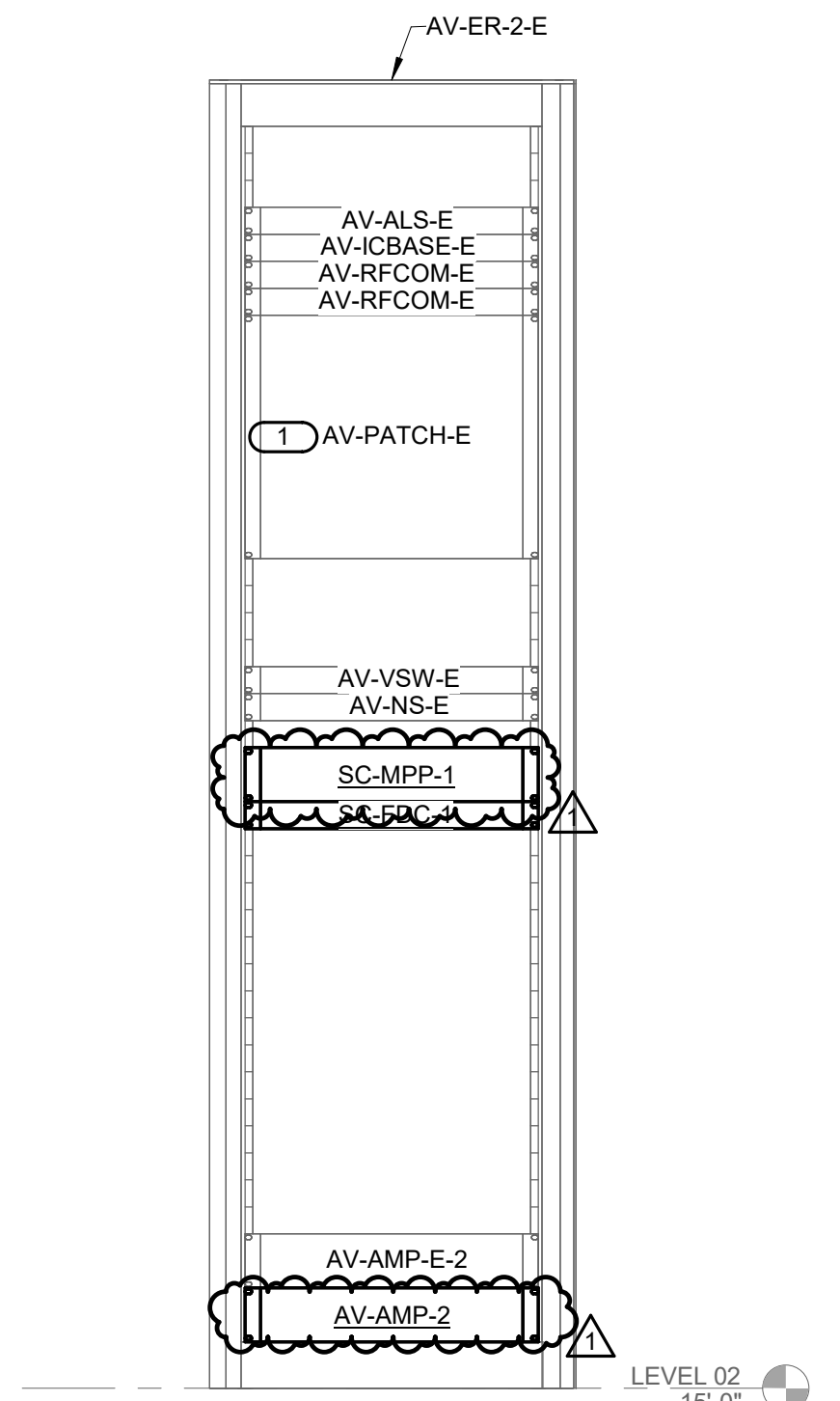

### 2 EXISTING CONTROL BOOTH AV RACK

- NO SCALE  
NOTES:  
1. LOCATIONS OF NEW AND EXISTING DEVICES SHOWN FOR CONCEPT ONLY. CONTRACTOR TO VERIFY LOCATIONS OF EXISTING EQUIPMENT.  
KEYNOTES: **#**  
1. OWNER TO DISCONNECT FIELD CABLES FROM PATCH PANELS THAT ROUTE FROM BOTH AV-WP1-E-W AND INSTALL AN XLR-M ON EACH CABLE AND PATCHED INTO DIGITAL SNAKE BOX IN CONTROL BOOTH.

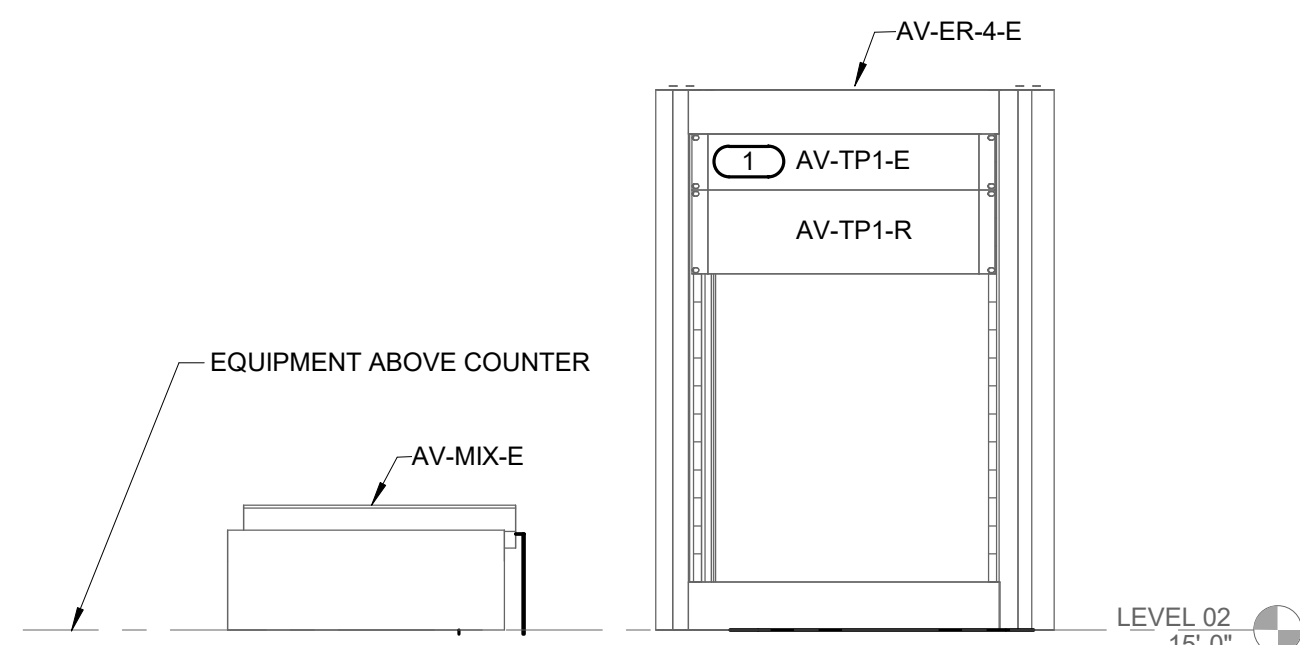

### 3 EXISTING MIX POSITION AV RACK

- NO SCALE  
NOTES:  
1. LOCATIONS OF NEW AND EXISTING DEVICES SHOWN FOR CONCEPT ONLY. CONTRACTOR TO VERIFY LOCATIONS OF EXISTING EQUIPMENT.  
KEYNOTES: **#**  
1. REMOVE EXISTING DEVICE AND TURN OVER TO OWNER. USE SPACE AVAILABLE AFTER DEMOLITION TO OPTIMIZE LOCATIONS OF NEW EQUIPMENT.

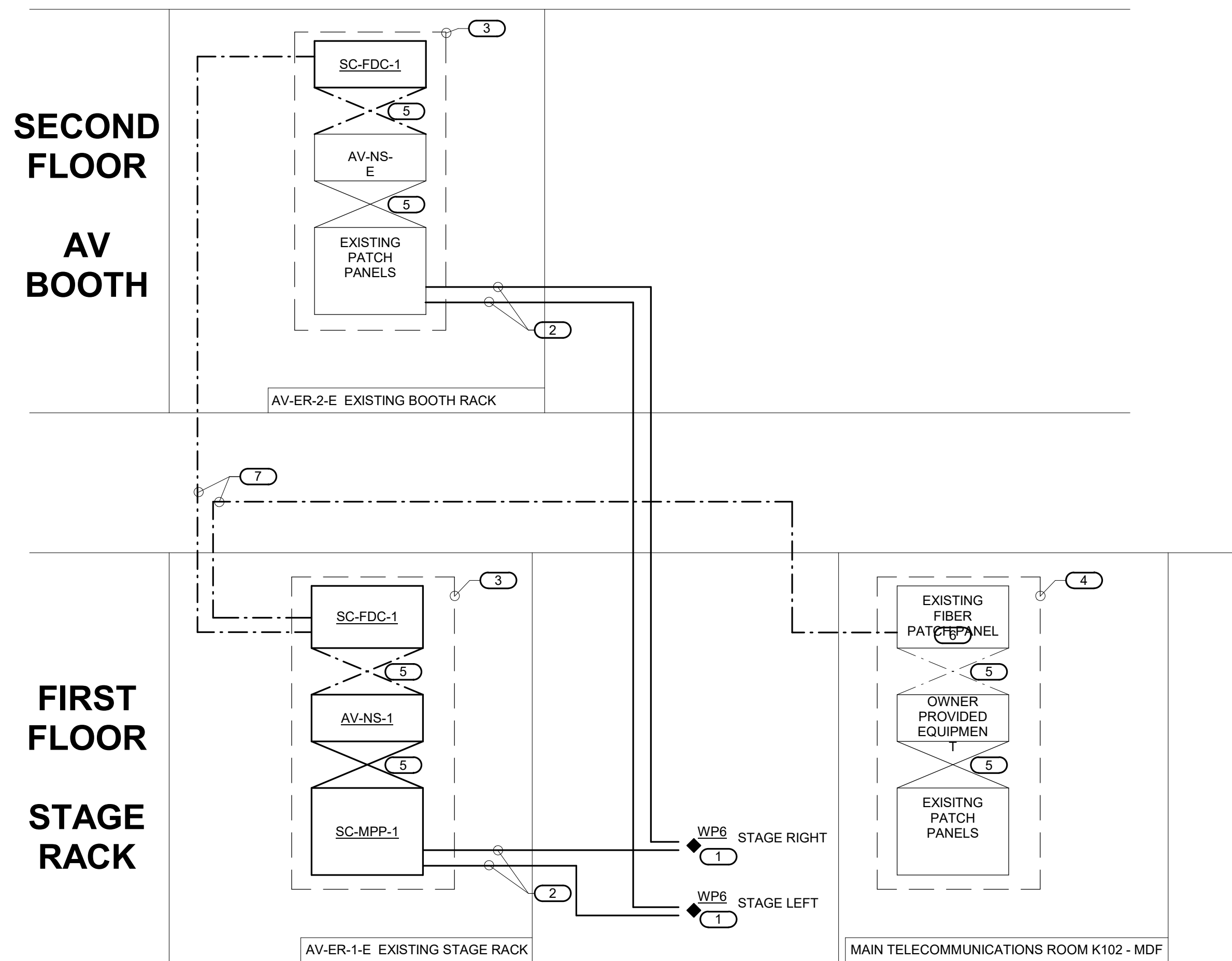

### 4 FIBER AND COPPER RISER DIAGRAM

- NO SCALE  
NOTES:  
1. THIS RISER IS DIAGRAMMATIC AND MAY NOT SHOW ACTUAL ROUTING OR QUANTITIES OF MATERIALS SHOWN. THIS RISER IS SHOWN FOR CLARIFICATION OF CONNECTION(S), LOCATIONS AND CABLE TYPE. ALL INFORMATION OUTLINES ARE TYPICAL OF THE OUTLETS IN THE AREA SHOWN. REFER TO FLOOR PLANS FOR MORE SPECIFIC ROUTING INFORMATION. REFER TO SPECIFICATIONS FOR ADDITIONAL REQUIREMENTS.  
2. REFER TO AV RISER DIAGRAM 1/AV400 FOR ADDITIONAL INFORMATION  
3. CONTRACTOR TO PROVIDE TESTING FOR ALL NEW CATEGORY CABLE AND FIBER SPECIFIED WITH TEST REPORT TO OWNER FOR CONFIRMATION OF PERFORMANCE.  
KEYNOTES:  
1. REFER TO TECHNOLOGY EQUIPMENT SCHEDULE FOR FACEPLATE CONFIGURATION. PROVIDE STAGE RIGHT AND STAGE LEFT PLATES EACH WITH (6) CAT6 CONNECTIONS TO BOOTH RACK AV-ER-2-E AND (4) CAT6 CONNECTIONS TO STAGE RACK AV-ER-1-E.  
2. 4-PAIR, CATEGORY 6, UNSHIELDED TWISTED PAIR CABLE. PROVIDE AS PANDUIT MODEL TX6 SERIES OR EQUAL.  
3. EXISTING AV RACK. COORDINATE WITH OWNER FOR FINAL RACK LAYOUT AND ASSOCIATED OWNER INSTALLED DEVICES.  
4. EXISTING TELECOMMUNICATIONS RACK IN EXISTING MDF. COORDINATE WITH OWNER FOR EXISTING CONDITIONS. REFER TO SPECIFICATIONS FOR FIBER PATCH CORD REQUIREMENTS.  
5. OWNER FURNISHED FIBER OR COPPER PATCH CORDS.  
6. EXISTING BELDEN FIBER ENCLOSURE IN EXISTING MDF. CONTRACTOR TO FURNISH AND INSTALL NEW LC SM 6 PORT FIBER ADAPTER PANEL MODEL PCSX06LDF1.  
7. PROVIDE 6-STRAND SINGLE MODE, ARMORED, PLENUM RATED FIBER, PANDUIT MODEL AP0061PNUJLPA WITH LC TERMINATION. CONTRACTOR TO FURNISH, INSTALL, TERMINATE AND TEST ALL FIBER SPECIFIED WITH CONNECTIONS AT MDF, STAGE RACK AND BOOTH RACK.

# 1 AV RISER DIAGRAM

NO SCALE  
NOTES:

1. AV CONTRACTOR SHALL TEST AND TAG ALL EXISTING WHEN REUSED. BEFORE DEMOLITION OCCURS ONSITE.
2. PROVIDE A SCHEDULE OF TESTED INPUTS AND OUTPUTS FOR EXISTING GEAR WITH DATE OF TEST.
3. ALL MATERIAL TAGS ENDING WITH "E" REPRESENT EXISTING EQUIPMENT. EXISTING EQUIPMENT SHALL BE INTERFACED WITH NEW EQUIPMENT AS THE AV RISER DIAGRAM SHOWS. ALL OTHER EQUIPMENT IS TO BE PROVIDED BY AV CONTRACTOR AND IS SHOWN ON TECHNOLOGY EQUIPMENT SCHEDULE ON SHEET AV600.

KEYNOTES: **E**

1. REFER TO MANUFACTURER REQUIREMENTS AND UPDATE DIP SWITCHES IN EXISTING TELEX MASTER STATION TO PROVIDE CONNECTION TO NEW CLEARCOM MASTER STATION AND INTEGRATE EXISTING WIRED INTERCOM TO NEW WIRELESS INTERCOM SYSTEM.
2. PROVIDE TOUCH PANEL CONTROL FROM STAGE RACK AND DUPLICATE CONTROL FROM CONTROL BOOTH. COORDINATE WITH PFAC FOR FINAL CONTROL REQUIRED TO INCLUDE BUT NOT LIMITED TO:
  - A. SYSTEM ON/OFF
  - B. PRESET MODE SELECTION: SIMPLE USE OR FULL PRODUCTION
  - C. SIMPLE USE CONTROL OF PROJECTOR AND SOURCE SELECT FOR VIDEO PRESENTATION
  - D. SIMPLE USE MAIN TALKER AND MEDIA VOLUME CONTROL WITH LIMITED QUANTITY WIRELESS MICROPHONES AND WIRED MICROPHONE VOLUME CONTROL.
3. REFER TO DETAIL 4/AV300 FOR FIBER CONNECTION BETWEEN STAGE RACK AND BOOTH RACK.
4. REFER TO DETAIL 4/AV300 FOR FIBER CONNECTION TO SCHOOL MDF.
5. DIGITAL AUDIO TRANSPORT OVER AV NETWORK SWITCHES. THIS ROUTING IS CONCEPTUAL AS ACTUAL SIGNALS ARE TRANSPORTED VIA NETWORK TOPOLOGY.
6. AV BRIDGE IS USED SO THE AUDIO DSP (AV-DSP-1) CAN MANAGE BOTH AVB AUDIO SIGNALS AND DANTE AUDIO SIGNALS.
7. EXISTING AV-WP1-E AUDIO INPUT PLATES ON STAGE CURRENTLY CABLE BACK AND CONNECT TO EXISTING TRS PATCH PANEL (AV-PATCH-E) IN SOUND BOOTH. OWNER TO REMOVE FROM PATCH PANEL, INSTALL MALE XLRs, AND PATCH INTO EXISTING DIGITAL AUDIO CONSOLE (AV-MIX-E).
8. EXISTING AUDIO INPUT JACKS LOCATED ON AV-ER-1-E STAGE RACK TO BE RECONNECTED TO NEW DSP AND UTILIZED.

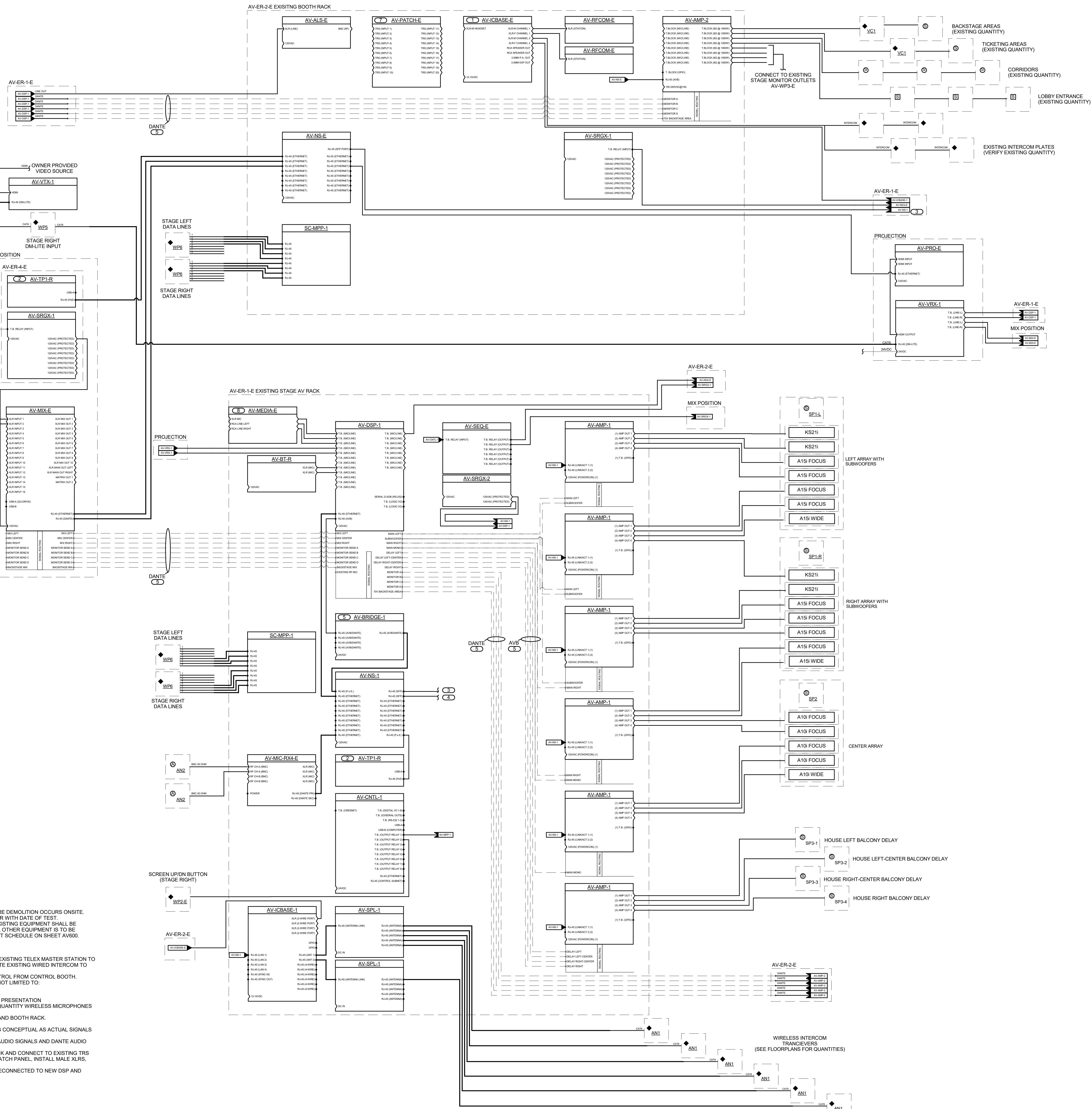

## Pike High School Performing Arts Center Renovation

INDIANAPOLIS, INDIANA

FANNING HOWEY

**IMEG**  
The Future. Built Smarter. [www.imegcorp.com](http://www.imegcorp.com)  
8900 KEYSTONE CROSSING  
SUITE 210  
INDIANAPOLIS, IN 46240  
P: 317.848.5045 F: 317.844.2201

PROFESSIONAL SEAL

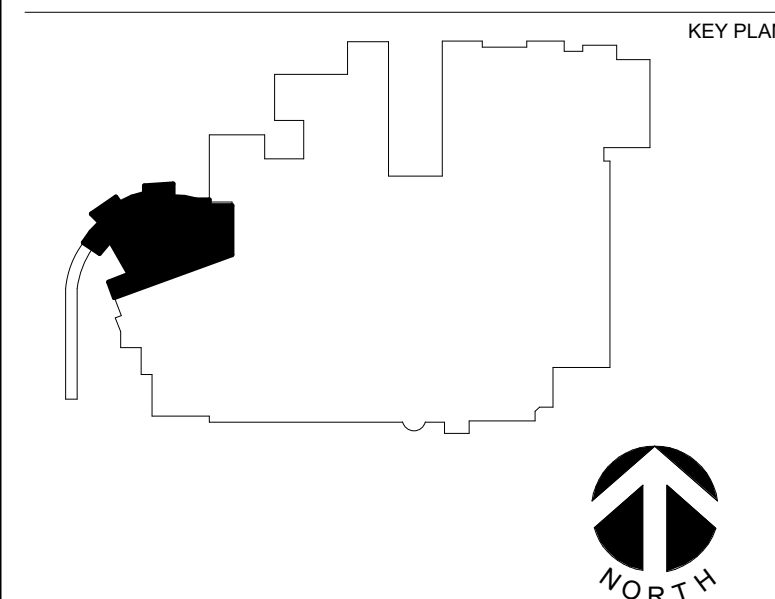

AGENCY APPROVAL

DISCLAIMER  
IMEG RESERVES PROPRIETARY RIGHTS, INCLUDING COPYRIGHTS, TO THIS DRAWING AND THE DATA SHOWN THEREON. SAID DRAWING AND/OR DATA ARE THE EXCLUSIVE PROPERTY OF IMEG AND SHALL NOT BE USED OR REPRODUCED FOR ANY OTHER PROJECT WITHOUT THE EXPRESS WRITTEN APPROVAL AND PARTICIPATION OF IMEG.  
©2024 IMEG CONSULTANTS CORP.

REVISIONS

No. Date Revision / Issue  
1 2/22/2024 Addendum 1

SHEET INFORMATION  
Issue **CONSTRUCTION DOCUMENTS**  
Date **2/6/2024**  
Project # **23001750.00**  
Drawn **Author**  
Checked **Checker**  
Approved **Approver**

SHEET TITLE  
**AV DETAILS**

SCALE  
Scale: **12" = 1'-0"**

SHEET NUMBER

**AV400**



LOUDSPEAKER LOCATION AND AIM SCHEDULE									
SPEAKER	MODEL	DELAY (MS)	LOCATION (FT)			SPEAKER AIM (DEGREES)			
			X	Y	Z	HORIZONTAL	VERTICAL	ROTATION	
SP1-L	KS21i	0	24	5	30	0	0	0	
	KS21i	0					0	0	
	A15i FOCUS	0					2	0	
	A15i FOCUS	0	-3	0					
	A15i FOCUS	0	-13	0					
	A15i FOCUS	0	-23	0					
SP1-R	A15i WIDE	0	-24	5	30	0	-43	0	
	KS21i	0					0	0	
	KS21i	0					0	0	
	A15i FOCUS	0	2	0					
	A15i FOCUS	0	-3	0					
	A15i FOCUS	0	-13	0					
SP2	A15i FOCUS	0	-27	5	30	0	-23	0	
	A15i FOCUS	0					-43	0	
	A15i WIDE	0					-1	0	
	A15i FOCUS	0	-6	0					
	A15i FOCUS	0	-16	0					
	A15i FOCUS	0	-26	0					
SP3-1	X-6i	TBD	0	8	34	0	-46	0	
SP3-1	X-6i	TBD	-30	76	12	-15	-10	0	
SP3-2	X-6i	TBD	-11	79	12	0	-10	0	
SP3-3	X-6i	TBD	11	79	12	0	-10	0	
SP3-4	X-6i	TBD	30	76	12	15	-10	0	
LEGEND									
CONFIRM REFERENCE POSITION ON AV CONTRACTOR SHOP SUBMITTALS BEFORE INSTALLATION. CONTRACTOR SHALL VERIFY REFERENCE POINTS, INCLUDING CENTERLINE REFERENCE AND 0 POINT REFERENCE AND DIRECTION BEFORE WORK BEGINS.									
SPEAKER POINT		FRONT TOP CENTER OF THE BOX.							
DELAY		DELAY IN MILLISECONDS FOR DSP SETTINGS.							
LOCATION X		DISTANCE FROM STAGE CENTER-LINE IN FEET.							
LOCATION Y		DISTANCE FROM PROCENIUM WALL IN FEET.							
LOCATION Z		DISTANCE ABOVE FLOOR IN FEET.							
HORIZONTAL AIM		PLAN VIEW AIM ANGLE 0° IS AIMED AT SOUTHWALL; 90° AT EAST WALL; 180° AT NORTH WALL.							
VERTICAL AIM		DOWN ANGLE FROM HORIZONTAL AXIS THAT IS PARALLEL TO LEVEL FLOOR.							
ROTATION		LOUDSPEAKER CABINET FACE ROTATION FROM PERPENDICULAR VERTICAL AXIS.							
NOTES									
1. COORDINATE LOUDSPEAKER AIM WITH ALL FIELD CONDITIONS AND SHOP SUBMITTALS. ADJUST FOR FIELD CONDITIONS TO MAINTAIN COVERAGE IN SEATS. VERIFY CABINET ROTATION AND HORN ROTATION.									
2. CONTRACTOR TO FIELD VERIFY EACH AIM LOCATION AT ROUGH-IN. NOTIFY CONSULTANT IMMEDIATELY FOR ANY CONFLICT TO CLEAR SIGHT LINES. CONFIRM ASSOCIATED TRADE WORK ON SITE, INCLUDING BUT NOT LIMITED TO DUCT, LIGHTS, CURTAINS, ELECTRICAL, MECHANICAL, BASKETBALL GOALS, CLOUDS, ETC. SEE ARCHITECTURALS FOR COMPLETE SCOPE AND COORDINATE OF SAME.									
3. SHOULD FIELD CONFIRMATION NOT BE MADE IN A TIMELY FASHION, CONTRACTOR IS RESPONSIBLE FOR IMPACT OR DELAY RESULTING, INCLUDING REWORK OR LIFT REQUIREMENTS FOR ACCESS TO RE-AIM.									
4. SUBMITTAL/SHOP DRAWINGS SHALL DETAIL P.E. RATED ATTACHMENT AND SUSPENSION HARDWARE USED. NO ATTACHMENT SHALL BE MADE WITHOUT USE OF P.E. RATED HARDWARE. SAFETY FACTORS ARE 5:1 OR GREATER. INCORPORATE SPECIFICATIONS INCLUDING P.E. RATED SUSPENSIONS FOR ALL OVERHEAD SUSPENSION ITEMS WITHOUT FAIL. MAINTAIN SAFE WORKING CONDITIONS AT ALL TIMES.									
5. INCORPORATE ALL MANUFACTURER'S RECOMMENDATIONS FOR RIGGING. READ AND REVIEW ALL LOUDSPEAKER AIM SUSPENSION ITEMS BEFORE FIELDWORK STARTS. AV CONTRACTOR RESPONSIBLE SHALL CONFIRM RIGGING POINT IN ADVANCE AND PER ANSI E1.8.									
6. SHOULD FIELD MODIFICATIONS OR ADJUSTMENTS BE REQUIRED DUE TO CONFLICTS FOR PROPER COVERAGE AND CLEAR SIGHT LINES, ADJUST FOR SAME COVERAGE AND SIGHT LINES WITH NEW POSITIONS. TEST FOR COVERAGE AT MID-BAND (2KHz OCTAVE BAND).									
7. IT IS FULLY REQUIRED THAT A QUALIFIED AV SOUND CONTRACTOR BE ON SITE DURING ALL SPEAKER AIM. IT IS NOT INTENDED THAT ELECTRICAL OR GENERAL CONTRACTOR SUSPEND OR AIM SPEAKERS WITH AV CONTRACTOR IN ATTENDANCE.									

AV EQUIPMENT SCHEDULE		
THE EQUIPMENT LIST ABBREVIATIONS AND THE TECHNOLOGY EQUIPMENT SCHEDULE ARE FOR THE CONVENIENCE OF THE CONTRACTOR. EACH CONTRACTOR SHALL BE RESPONSIBLE FOR VERIFICATION OF QUANTITIES AND SHALL FURNISH ALL MATERIAL REQUIRED, WHETHER SPECIFIED OR NOT, TO PRODUCE A SATISFACTORY WORKING SYSTEM.		
CATALOG NUMBERS ARE NOT TO BE CONSIDERED COMPLETE BUT ARE GIVEN ONLY TO AID THE CONTRACTOR IN THE SEARCH FOR MATERIAL. NO MATERIAL SHALL BE ORDERED BY MANUFACTURER AND CATALOG NUMBER ONLY. EACH CONTRACTOR SHALL FIRST READ THE COMPLETE DESCRIPTION OF THE MATERIAL ON THESE DRAWINGS AND SPECIFICATIONS. THE FIRST MANUFACTURER LISTED IS THE BASIS OF DESIGN. "STANDARD COLOR" INDICATES FACTORY FINISH AVAILABLE AT NO ADDITIONAL CHARGE.		
EQUIPMENT LIST ABBREVIATION	EQUIPMENT LIST DESCRIPTION	MANUFACTURER AND MODEL
AV-ALS-E	EXISTING ASSISTED LISTENING SYSTEM LOCATED IN BOOTH AV RACK. PROVIDE LINE LEVEL AUDIO CABLEING FROM DSP IN STAGE AV RACK. REFER TO RISER DIAGRAM ON SHEET AV400 FOR CONNECTIVITY.	EXISTING TO REMAIN
AV-AMP-1	AUDIO AMPLIFIER CONTROLLER. RACK MOUNTED 4 INPUT X 4 OUTPUT ARCHITECTURE WITH AN OUTPUT POWER OF 4 X 1300 WATTS @ 8 OHMS AT 1 % THD AND AV SMP'S POWER SUPPLY WITH PFC AND HIGH EFFICIENCY CLASS D AMPLIFICATION. 32 BIT FLOATING POINT DSP WITH 96KHZ SAMPLING FREQUENCY AND 24 BIT AD CONVERTERS. REQUIRES 30 AMP CIRCUIT.	L-ACOUSTICS LAXX
AV-AMP-2	AUDIO AMPLIFIER RACK MOUNTED FLEXIBLE AMPLIFIER SUMMING WITH EIGHT CHANNEL 600W SINGLE CHANNEL RATED (CONTINUOUS) FOR 8 OHMS TO 2 OHMS SAFELY AT FULL BANDWIDTH PERFORMANCE. FOUR 3-PIN MIC/LINE INPUTS FOR DIGITAL AUDIO NETWORK AND RJ-45 FOR DIGITAL AUDIO LAN CONNECTION. LOCK OUT ALL FRONT PANEL MOUNTED CONTROLS EXPOSED. EXCEPT POWER ON/OFF. VERIFY ANY EQUALS FOR SAME EXACT LOAD ASSIGNMENTS AND MATCH SPEAKERS AND AMPS AS SPECIFIED.	CROWN DCI 8600DA
AV-AMP-E-1	EXISTING BOSE AUDIO AMPLIFIERS. AV CONTRACTOR TO DEMOLISH AMPLIFIERS AND TURN OVER TO OWNER.	EXISTING TO REMAIN
AV-AMP-E-2	EXISTING BACK OF HOUSE AUDIO AMPLIFIER IN EXISTING BOOTH AV RACK SERVING THE 70 VOLT CIRCUIT ON NORTH SIDE OF BACK OF HOUSE AREAS. AV CONTRACTOR TO DEMOLISH AMPLIFIER AND TURN OVER TO CUSTOMER. TEST AND CONNECT SPEAKER LINES TO NEW AMPLIFIER AV-AMP-2. SEE RISER DIAGRAM ON SHEET AV400 FOR CONNECTIVITY.	EXISTING TO REMAIN
AV-ANT-C	PRODUCTION INTERCOM ANTENNA-CEILING MOUNT. IP WIRELESS INTERCOM ANTENNA. 1.9GHZ. UNIT INCLUDES TWO RJ45 PORTS. TWO SFP FIBER PORTS. POE POWER.	CLEARCOM FSII-TQVR-IP-19-US
AV-ANT-W	PRODUCTION INTERCOM ANTENNA-WALL MOUNT. IP WIRELESS INTERCOM ANTENNA. 1.9GHZ. UNIT INCLUDES TWO RJ45 PORTS. TWO SFP FIBER PORTS. POE POWER.	CLEARCOM FSII-TQVR-IP-19-US
AV-ANZ-E	EXISTING WIRELESS MIC PAD/LE ANTENNAS AND RELOCATE FROM AV-ER-2 ROOM RACK TO CATWALK AREA AS SHOWN ON PLANS. PROVIDE MOUNTING HARDWARE AS NECESSARY AND RG-58 CABLES TO EXISTING RACK.	EXISTING
AV-BRIDGE-1	NEW AVB TO DANTE BRIDGE. 4-PORT AVB-CAPABLE POE-NETWORK DEVICE WHICH CAN BE CONFIGURED AS A DANTE OR AVB INTERFACER TO A TESIRA SYSTEM UNIT TO BE INSTALLED IN STAGE AV RACK. PROVIDE OPTIONAL 10/100/1000BASE-T RJ-45 PORTS TO SUPPORT 10/100/1000BASE-T NETWORK CONNECTION.	BIAMP CONNECT TC-SD
AV-BT-R	BLUETOOTH RECEIVER. RACKMOUNT IN STAGE RACK AV-ER-1-E. REQUIRES 1RU OF SPACE.	DENON DN-X800R
AV-CNTL-1	AV SYSTEM CONTROLLER. CONTRACTOR TO INSTALL NEW 19" RACKMOUNT CRESTION CONTROLLER INTO EXISTING STAGE AV RACK. AV-ER-1-E. REQUIRES CONNECTION TO NEW ETHERNET SWITCH FOR AV CONTROL. UNIT SHALL CONTROL ALL AV EQUIPMENT AND INTEGRATE WITH TOUCHSCREENS. AV-TP1-R. FOR USER INTERFACE.	CRESTRON CF4N
AV-DSP-1	DIGITAL SIGNAL PROCESSOR. SOFTWARE CONFIGURABLE AUDIO PROCESSOR WITH 12 ANALOG INPUTS X 8 ANALOG OUTPUTS, USB, AND (1) ETHERNET PORTS FOR AVB AND (1) ETHERNET PORT FOR CONTROL. REFER TO SPECIFICATION 27.41.01 FOR CONFIGURATION AND PERFORMANCE REQUIREMENTS.	TESIRA FORTE AVB AI
AV-DSP-E	EXISTING DSP IN STAGE AV RACK TO BE DEMOLISHED AND TURNED OVER TO OWNER.	EXISTING TO REMAIN
AV-ER-1-E	EXISTING STAGE AV RACK. 44 RU AV EQUIPMENT RACK LOCATED DOWNSTAGE RIGHT.	EXISTING TO REMAIN
AV-ER-2-E	EXISTING BOOTH AV RACK. 44 RU AV EQUIPMENT. LOCATED IN SOUND BOOTH. PRIMARILY REFERENCING THE LEFT OF THE TWO CABINETS.	EXISTING TO REMAIN
AV-ER-4-E	EXISTING MIX POSITION RACK. 16 RU TABLE-TOP RACK. LOCATED IN SOUND BOOTH NEXT TO AUDIO MIX CONSOLE.	EXISTING TO REMAIN
AV-HH-1	HAND-HOLD FOR PASSING CABLES THROUGH WALL FOR TEMPORARY MIX POSITION.	ACOUSTIC SCIENCES CORPORATION
AV-IC-E-W	EXISTING PRODUCTION INTERCOM WALL PLATE.	EXISTING TO REMAIN
AV-IC-W	REFER TO AV RISER DIAGRAM 1/AV400 FOR CONTRACTOR INTERACTION INTO NEW DESIGN.	TELEX WP-3
AV-ICBASE-1	PRODUCTION INTERCOM BASE STATION. WIRELESS AND WIRED INTERCOM BASE STATION WITH CAPABILITY TO SUPPORT UP TO SIX IPT OR FSE TRANSCIEVERS AND UP TO TEN E1 TRANSCIEVERS (1.0 OR 2.4 CHZ). INCLUDES 3 4-WIRE PORTS, 2 WIRE PORTS, QP/O AND LAN.	CLEARCOM (1) FSE-BASE (1) FSII-BP19-X4-US (6) CC-400-X4 (6) AC200
AV-ICBASE-E	EXISTING TELEX PRODUCTION INTERCOM BASE STATION.	EXISTING TO REMAIN
AV-MIC-RX4-E	EXISTING 4-CHANNEL WIRELESS MIC RECEIVER. RELOCATE UNIT FROM EXISTING CONTROL BOOTH RACK AV-ER-2-E TO EXISTING STAGE AV RACK AV-ER-1-E. AV CONTRACTOR TO CONNECT DANTE OUTPUTS TO DIGITAL AUDIO NETWORK SWITCH LOCATED IN STAGE AV RACK. AV-ER-1-E. RF MIC PAD/LE ANTENNAS TO BE RELOCATED FROM BOOTH TO CATWALK.	EXISTING TO REMAIN
AV-MIX-E	EXISTING ALLEN AND HEATH SO-5 MIXER WITH DANTE CARD INSTALLED. CONNECT DANTE I/O CARD TO EXISTING AV NETWORK SWITCH IN CONTROL BOOTH. CONTRACTOR TO LOCATE AV NETWORK SWITCH AND PROVIDE CABLES OF NECESSARY LENGTH TO COMPLETE PATCH AS NEEDED. COORDINATE PATH BETWEEN MIXER AND NETWORK SWITCH AS REQUIRED.	EXISTING TO REMAIN
AV-NS-1	AUDIO SYSTEM AVB/TSN ETHERNET NETWORK SWITCH TO BE LOCATED IN EXISTING STAGE AV RACK AV-ER-1-E. PROVIDE COMMERCIAL GRADE DATA SWITCH WITH AVB AND DANTE COMPATIBILITY. PER DSP MANUFACTURER REQUIREMENTS, LATEST VERSION AVAILABLE. UNITS SHALL BE MANAGED LAYER 2+3 LITE. GIGABIT ETHERNET SWITCHES. FORTY-EIGHT (48) 10/100/1000BASE-T RJ-45 PORTS, EIGHT WITH POE, WITH EAV LICENSE. 1 RU RACKMOUNT CHASSIS. INCLUDE RACK MOUNT OPTION.	OWNER FURNISHED CONTRACTOR INSTALLED. OWNER CONFIGURED
AV-NS-E	SWITCH TO BE MANAGED AND PROGRAMMED BY OWNER ON NETWORK WITH SEPERATE VLANS FOR AVB, DANTE, AND DATA.	EXISTING TO REMAIN

AV EQUIPMENT SCHEDULE		
THE EQUIPMENT LIST ABBREVIATIONS AND THE TECHNOLOGY EQUIPMENT SCHEDULE ARE FOR THE CONVENIENCE OF THE CONTRACTOR. EACH CONTRACTOR SHALL BE RESPONSIBLE FOR VERIFICATION OF QUANTITIES AND SHALL FURNISH ALL MATERIAL REQUIRED, WHETHER SPECIFIED OR NOT, TO PRODUCE A SATISFACTORY WORKING SYSTEM.		
CATALOG NUMBERS ARE NOT TO BE CONSIDERED COMPLETE BUT ARE GIVEN ONLY TO AID THE CONTRACTOR IN THE SEARCH FOR MATERIAL. NO MATERIAL SHALL BE ORDERED BY MANUFACTURER AND CATALOG NUMBER ONLY. EACH CONTRACTOR SHALL FIRST READ THE COMPLETE DESCRIPTION OF THE MATERIAL ON THESE DRAWINGS AND SPECIFICATIONS. THE FIRST MANUFACTURER LISTED IS THE BASIS OF DESIGN. "STANDARD COLOR" INDICATES FACTORY FINISH AVAILABLE AT NO ADDITIONAL CHARGE.		
EQUIPMENT LIST ABBREVIATION	EQUIPMENT LIST DESCRIPTION	MANUFACTURER AND MODEL
AV-PATCH-E	EXISTING PATCH BAYS IN BOOTH AV RACK. OWNER TO REMOVE AUDIO LINES COMING FROM BOTH STAGE LEFT AND RIGHT. AV-VP1-E PANELS FROM THE EXISTING TRS PATCH BAY IN SOUND BOOTH. OWNER TO REPURPOSE CABLES BY INSTALLING XLR-M CONNECTORS ON THE ENDS IN BOOTH AND PATCH EACH CABLE INTO EXISTING AUDIO MIXING CONSOLE LOCATED IN THE BOOTH.	EXISTING TO REMAIN
AV-PRO-E	EXISTING PRODUCTION INTERCOM BASE STATION. WIRELESS AND WIRED INTERCOM BASE STATION WITH CAPABILITY TO SUPPORT UP TO SIX IPT OR FSE TRANSCIEVERS AND UP TO TEN E1 TRANSCIEVERS (1.0 OR 2.4 CHZ). INCLUDES 3 4-WIRE PORTS, 2 WIRE PORTS, QP/O AND LAN.	EXISTING TO REMAIN
AV-RFCOM-E	EXISTING CLEARCOM WIRELESS PRODUCTION INTERCOM BASE STATION.	EXISTING TO REMAIN
AV-RLM-E	REFER TO AV RISER DIAGRAM 1/AV400 FOR CONTRACTOR INTERACTION INTO NEW DESIGN.	EXISTING TO REMAIN
AV-SEQ-E	EXISTING POWER SEQUENCER LOCATED IN STAGE AV RACK. INTEGRATE TO NEW CRESTION CONTROL SYSTEM. REFER TO AV RISER DIAGRAM 1/AV400 AND ELECTRICAL DIAGRAM 1/AV401 FOR CONTROL REQUIREMENTS.	EXISTING TO REMAIN
AV-SP1-C	MAIN LEFT AND MAIN RIGHT WITH SUBWOOFER LIDS. SPEAKER ARRAYS. INSTALLATION VERSION. CONSTANT CURVATURE LINE SOURCE ARRAY. IN HORIZONTAL MOUNT. ARRAY INCLUDES 2-WAY PASSIVE WITH 15" LF + 3" HF DIAPHRAGM IN 30" ENCLOSURES. PROVIDE SUSPENSION PER MANUFACTURER REQUIREMENTS. EACH CABINET LOAD SHALL BE VERIFIED ON SUBMITTALS AND SECURED WITH ADDED SAFETY CABLE. ARRAY WEIGHT IS 300 LBS AND OVERALL DIMENSIONS ARE 5' W X 3' D X 3.5' TALL. SEE SPECIFICATION 27.41.01 FOR LOUDSPEAKER RIGGING AND P.E. STAMP REVIEW REQUIREMENTS. REFER TO SHEET TAB10 FOR LOUDSPEAKER LOCATION AND AIM SCHEDULE. PROVIDE STANDARD BOX OR CONDUIT STUB-OUT ON ROOF TRUSS AT SPEAKER SUSPENSION POINT WITH 1-1/4" CONDUIT FOR SPEAKER LINES TO STAGE AV RACK AV-ER-1-E.	L-ACOUSTICS HORIZONTAL ARRAY: 4 QTY A101 FOCUS 2 QTY KS21i SUBWOOFERS 4 QTY A101 FOCUS 1 QTY A15i WIDE LINK ACCESSORIES
AV-SP2-C	CENTER LOUDSPEAKER ARRAY. INSTALLATION VERSION. CONSTANT CURVATURE LINE SOURCE ARRAY. IN HORIZONTAL MOUNT. ARRAY INCLUDES 2-WAY PASSIVE WITH 10" LF + 3" HF DIAPHRAGM IN 30" ENCLOSURES. PROVIDE SUSPENSION PER MANUFACTURER REQUIREMENTS. EACH CABINET LOAD SHALL BE VERIFIED ON SUBMITTALS AND SECURED WITH ADDED SAFETY CABLE. ARRAY WEIGHT IS 300 LBS AND OVERALL DIMENSIONS ARE 5' W X 3' D X 3.5' TALL. SEE SPECIFICATION 27.41.01 FOR LOUDSPEAKER RIGGING AND P.E. STAMP REVIEW REQUIREMENTS. REFER TO SHEET TAB10 FOR LOUDSPEAKER LOCATION AND AIM SCHEDULE. PROVIDE STANDARD BOX OR CONDUIT STUB-OUT ON ROOF TRUSS AT SPEAKER SUSPENSION POINT WITH 1-1/4" CONDUIT FOR SPEAKER LINES TO STAGE AV RACK AV-ER-1-E.	L-ACOUSTICS HORIZONTAL ARRAY: 4 QTY A101 FOCUS 1 QTY A101 WIDE LINK ACCESSORIES
AV-SP3-C	UNDER BALCONY DELAY SPEAKERS. 2-WAY COAXIAL. PASSIVE ENCLOSURE WITH 8 IN / 1.5 IN SPEAKER PRODUCING AN AXISYMMETRIC POINT SOURCE DIRECTIVITY OF 90 DEGREES WITH CONSISTENT OFF-AXIS RESPONSE. PROVIDE BRACKETS. PROVIDE STANDARD BOX OR CONDUIT STUB-OUT ON ROOF TRUSS AT SPEAKER SUSPENSION POINT WITH 1-1/4" CONDUIT FOR SPEAKER LINES TO STAGE AV RACK AV-ER-1-E.	L-ACOUSTICS X-8i
AV-SP1-L	DIGITAL ANTENNA SPLITTER FOR FREESPEAK-HI TRANSCIEVER ANTENNAS. A SINGLE UNIT ALLOW (1) ANTENNA PORT ON THE BASE STATION TO CONNECT TO (8) FIELD LOCATED TRANSCIEVER ANTENNAS. DIMENSIONS ARE 1.65" H X 8.75" W X 7.75" D AND WEIGHS 24.5 OZ. PROVIDE SHELF OR MEANS FOR RACKMOUNTING AND SHORT BLADE PATCH CORDS. USE IN 7-1/2" DEEP EXTERNAL POWER SUPPLY.	CLEARCOM FSII-SPL
AV-SRGX-1	INSTALL (1) UNIT IN EXISTING MIX POSITION RACK. AV-ER-4-E AND (1) UNIT IN EXISTING BOOTH RACK. AV-ER-2-E.	SURGEX SX-1115-RT
AV-SRGX-2	NEW SIGA FOR STAGE AV RACK. USE TO PROTECT AUDIO DSP AND NETWORK SWITCH.	SURGEX SA-82
AV-TP1-R	TOUCH PANEL-RACK MOUNT. AUDIO SYSTEM TOUCH PANEL CONTROL. 7" SCREEN WITH 1024 x 600 RESOLUTION AND P.O.E. POWERED.	CRESTRON TSW-760-S-S
AV-TP-E	EXISTING BOSE TOUCH PANEL IN STAGE AV RACK AND MIX POSITION RACK. DEMO BOTH.	EXISTING TO REMAIN
AV-VC-E-W	EXISTING PRODUCTION INTERCOM WALL PLATE.	EXISTING TO REMAIN
AV-VP5-E-C	EXISTING PRODUCTION SCREEN. NEW CRESTION CONTROL SYSTEM TO CONTROL SCREEN UP AND DOWN FUNCTIONS. PROVIDE CONTROL WIRING FROM EXISTING STAGE RIGHT WALL SWITCH. AV-WP2-E, TO NEW AV SYSTEM CONTROLLER LOCATED IN STAGE AV RACK AV-ER-1-E.	EXISTING TO REMAIN
AV-VRX-1	DM-LITE RECEIVER. INTEROPERABILITY WITH A DM LITE TRANSMITTER. AV-VTX-1 ON STAGE RIGHT TO PROVIDE POINT-TO-POINT EXTENSION OF AN HDMI SIGNAL OVER A CATEGORY 6 CABLE. PROVIDE CAT6 CABLE FROM WPS TO PROJECTOR HOUSING. UNIT TO SUPPORT 4K60 4:4:4 VIDEO, HDR10+, AND HDCP 2.3. SECURE UNIT IN PROJECTOR HOUSING AS REQUIRED. POWER FROM 24VDC POWER PACK (INCLUDED) AND CONNECT TO POWER IN PROJECTOR HOUSING.	CRESTRON HD-RXA-4KZ-101
AV-VTX-1	DM-LITE TRANSMITTER. INTEROPERABILITY WITH A DM LITE RECEIVER. AV-VRX-1 IN PROJECTOR HOUSING TO PROVIDE POINT-TO-POINT EXTENSION OF AN HDMI SIGNAL OVER A CATEGORY 6 CABLE. SUPPORTS 4K60 4:4:4 VIDEO, HDR10+, AND HDCP 2.3. UNIT TO RECEIVE 24VDC POWER OVER CAT6 CABLE FROM RECEIVER. UNIT TO BE BROUGHT OUT BY STAFF FOR EVENTS AND PATCHED INTO WPS WALL PLATE ON STAGE RIGHT WHEN NEEDED.	CRESTRON HD-TX-4KZ-101
AV-WP1-E	EXISTING TO RLY IN PUT 1 PANEL. ONE ON STAGE LEFT AND STAGE RIGHT.	EXISTING TO REMAIN
AV-WP2-E	REFER TO AV RISER DIAGRAM 1/AV400 FOR CONNECTION DETAIL.	EXISTING TO REMAIN
AV-WP3-E	EXISTING STAGE MONITOR INPUT PLATE. ONE ON STAGE LEFT AND STAGE RIGHT.	EXISTING TO REMAIN
AV-WP4-E	EXISTING SUBWOOFER OUTPUT PLATE. ONE ON STAGE LEFT AND STAGE RIGHT.	EXISTING TO REMAIN
AV-WP5-W	DIGITAL MEDIA-LITE VIDEO INPUT WALL PLATE. PROVIDE STAINLESS STEEL SINGLE GANG PLATE WITH ETHERCON RG-45 CAT6 JACK. PROVIDE 25' RUBBER JACKETED ETHERCON DATA CABLE. LABEL AS DIGITAL VIDEO INPUT. DESIGN IS TO PATCH DIGITAL MEDIA-LITE TRANSMITTER. AV-VTX-1, TO PROJECTOR VIA WALL-PLATE.	EXISTING TO REMAIN, BUT NOT CURRENTLY UTILIZED.
AV-WP6-W	PROVIDE SURFACE MOUNT BOX AND SURFACE MOUNT RACEWAY UP TO GRID LEVEL FOR PATH TO PROJECTOR.	EXISTING TO REMAIN
AV-WP6-W	AV DATA PATCH PANEL. WALL PLATE WITH (10) CAT6 ETHERCON JACKS AND (2) BLANK JACKS. PROVIDE AS 8" X 8" WALL FRAME WITH 8.5" X 8.5" RECESSED INSERT PLATE.	WHIRLWIND WFB8x8 WFB8x81 (FLUSH) WFB8x8x1 (SURFACE)
AV-WP6-W	PROVIDE SURFACE MOUNT BOX AND SURFACE MOUNT RACEWAY UP TO GRID LEVEL FOR PATH TO PROJECTOR.	PROCO ENTERTAINMENT METALS
SC-FDC-1	FIBER OPTIC DISTRIBUTION CABINET. RACK MOUNT. ACCOMMODATES TWELVE (3) MODULAR ADAPTER PANELS OR MODULES. WELDED STEEL CONSTRUCTION. BLACK POWDER-COAT FINISH. INTEGRATED FRONT CABLE MANAGEMENT TROUGH. LOCKABLE. REQUIRES ONE (1) 1.75" RACK MOUNTING SPACES.	PANDUIT FFM1U FAP6WBDLDCZ PANEL F91BN1NNSNM001 PIG TALS
SC-MPP-1	CAT 6 RACKMOUNT MODULAR PATCH PANEL. INSTALL IN EXISTING STAGE RACK AV-ER-1-E. OWNER PROVIDED. CONTRACTOR INSTALLED. CONTRACTOR TO PROVIDE KEYSTONE JACKS AND CABLE. CONNECT NEWLY RUN DATA CABLES FROM AV-WP6-W WALL PLATES.	OR PRE-APPROVED EQUAL

Pike High School  
Performing Arts Center  
Renovation

INDIANAPOLIS, INDIANA

FANNING HOWEY



PROFESSIONAL SEAL

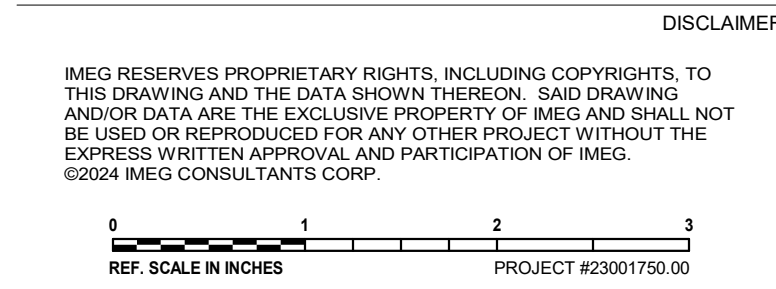
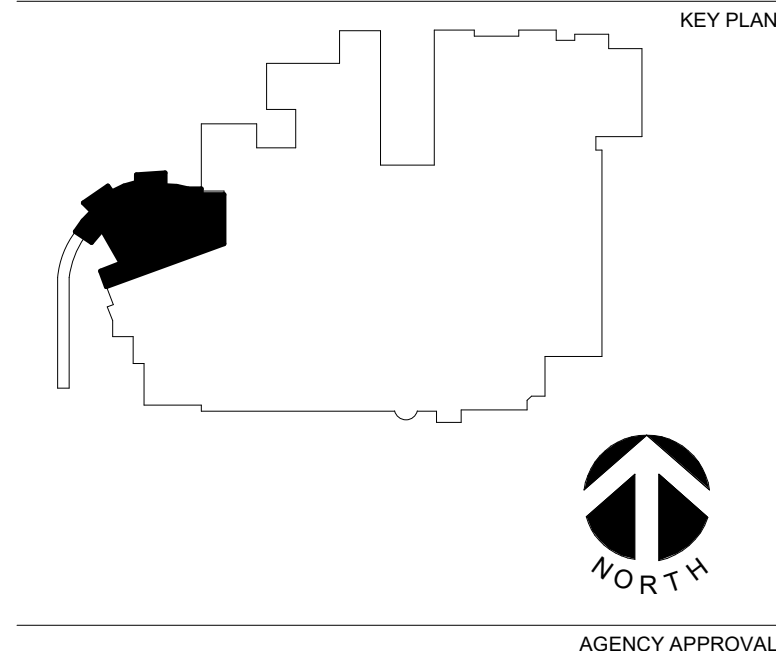

No.	Date	Revision / Issue
1	2/22/2024	Addendum 1

SHEET INFORMATION	
Issue	CONSTRUCTION DOCUMENTS
Date	2/6/2024
Project #	23001750.00
Drawn	Author
Checked	Checker
Approved	Approver

SHEET TITLE  
AV SCHEDULES

SCALE

SHEET NUMBER

AV600